

Data Sheet | Item Number: 787-1020

Switched-mode power supply; Compact; 1-phase; 5 VDC output voltage; 5.5 A output current; DC OK signal

<https://www.wago.com/787-1020>

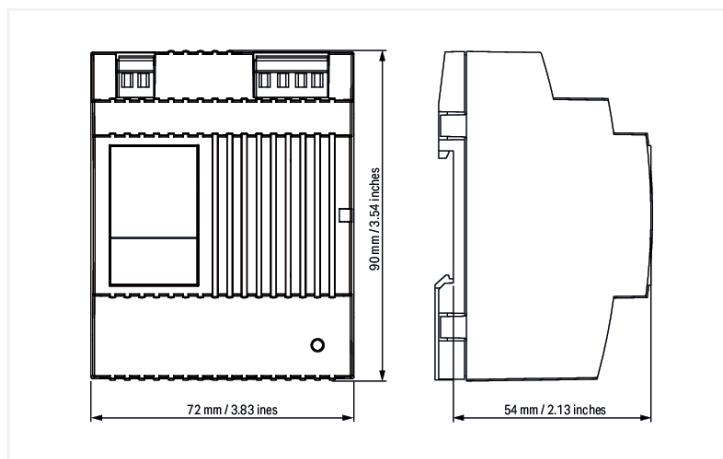
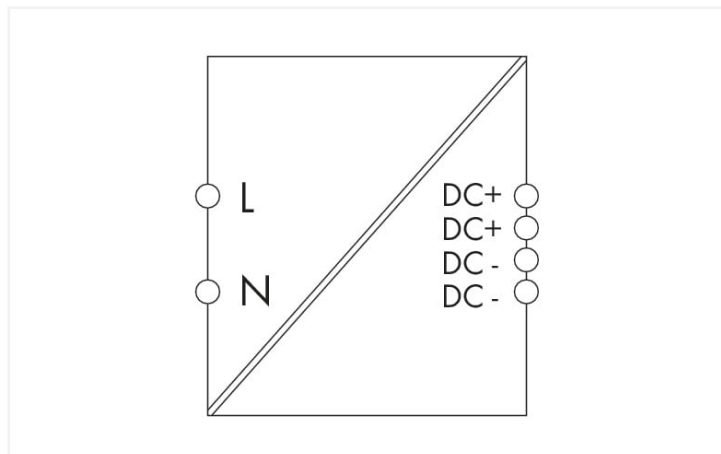

Features:

- Switched-mode power supply
- Natural convection cooling when horizontally mounted
- Stepped profile, ideal for distribution boards/boxes
- Overhead mounting is possible with derating
- Suitable for both parallel and series operation
- Electrically isolated output voltage (SELV) per EN 61010-2-201/UL 60950-1; PELV per EN 60204

Technical data

Input

Phases	1
Nominal input voltage $U_{i,nom}$	1 x AC 100 ... 240 V
Input voltage range	1 x AC 85 ... 264 V; DC 120 ... 300 V
Nominal mains frequency range	44 ... 66 Hz; 0 Hz
Input current I_i	≤ 0.29 A (230 VAC); ≤ 0.56 A (110 VAC)
Discharge current	≤ 1 mA
Inrush current	≤ 30 A (NTC)
Power factor correction (PFC)	passive
Mains failure hold-up time	≥ 80 ms (230 VAC); ≥ 10 ms (110 VAC)

Output

Nominal output voltage $U_{o,nom}$	DC 5 V (SELV)
Output voltage range	DC 4.5 ... 8.5 V (adjustable)
Default setting	DC 5 V
Nominal output current $I_{o,nom}$	5.5 A (5 VDC); 3.5 A (in any mounting position)
Nominal output power	27.5 W
Deviation	≤ 2 %
Residual ripple	≤ 100 mV (peak-to-peak)
Current limitation	$1.1 \times I_{o,nom}$ (typ.)
Overload behavior	Constant current

Signaling and communication

Signaling	1 x Status indication LED (green)
Operation status indicator	Green LED (U _o)

Efficiency/power losses

Power loss P _I	≤ 2.4 W; ≤ 9.4 W (230 VAC; nominal load)
Power loss (max.) P _{I(max)}	9.9 W (264 VAC / 5 VDC; 5.5 A)
Efficiency (typ.)	75 %

Circuit protection

Internal fuse	T 2 A / 250 VAC
Backup fusing (required)	An external DC fuse is required for the DC input voltage.
Backup fusing (recommended)	Circuit breaker: 6 A (C characteristic), 10 A (B characteristic) or higher

Safety and protection

Isolation voltage (pri.-sec.)	DC 4.242 kV
Protection class	II
Protection type	IP20; per EN 60529
Resistance to reverse feed	≤ DC 10 V
Overvoltage category	II
Pollution degree	2
Transient suppression (primary)	Varistor
Overvoltage protection; secondary	≤ 16 VDC (in the event of a fault)
Short-circuit-protected	Yes
Open-circuit-proof	Yes
Parallel operation	Yes
Series operation	Yes
MTBF	> 500,000 h (per IEC 61709)

Connection data

Connection type 1	Input/output
Connection technology	CAGE CLAMP®
WAGO connector	WAGO 740 Series
Solid conductor	0.08 ... 2.5 mm ² / 28 ... 12 AWG
Fine-stranded conductor	0.08 ... 2.5 mm ² / 28 ... 12 AWG
Strip length	6 ... 7 mm / 0.24 ... 0.28 inches

Physical data

Width	72 mm / 2.835 inches
Height	89 mm / 3.504 inches
Depth	59 mm / 2.323 inches
Depth from upper-edge of DIN-rail	55 mm / 2.165 inches

Mechanical data

Mounting type	DIN-35 rail
---------------	-------------

Material data

Flammability class per UL94	V0
Fire load	0 MJ
Weight	240 g

Environmental requirements

Ambient temperature (operation)	-25 ... +60 °C (Device starts at -40 °C (type-tested))
Ambient temperature (storage)	-25 ... +80 °C
Ambient temperature UL (operation at U _N)	-25 ... +55 °C
Relative humidity	5 ... 96 % (no condensation permissible)
Derating	-3 %/K (> 45 °C)

Standards and specifications

Conformity marking	CE
Standards/specifications	EN 61010-1 EN 61010-2-201 EN 61204-3 UL 60950-1 UL 508 DNV

Commercial data

eCl@ss 10.0	27-04-07-01
eCl@ss 9.0	27-04-07-01
ETIM 8.0	EC002540
ETIM 7.0	EC002540
PU (SPU)	1 pcs
Packaging type	Box
Country of origin	DE
GTIN	4055143098816
Customs tariff number	85044083900

Environmental Product Compliance

RoHS Compliance Status	Compliant, No Exemption
------------------------	-------------------------

Approvals / Certificates

General approvals



Approval	Standard	Certificate Name
EAC Brjansker Zertifizierungs- stelle	TP TC 004/2011, TP TC 020/2011	EAC RU C-DE.AM02. B.00089_19
UL Underwriters Laboratories Inc.	UL 508	E255817
UL Underwriters Laboratories Inc.	UL 60950-1	E255815

Declarations of conformity and manufacturer's declarations

Approval	Standard	Certificate Name
EU-Declaration of Confor- mity WAGO GmbH & Co. KG	-	-

Downloads

Environmental Product Compliance

Compliance Search

Environmental Product Compliance 787-1020



Documentation

Bid Text

787-1020	12.06.2019	docx 20.36 KB	
787-1020	24.06.2019	xml 6.83 KB	

Instruction Leaflet

Power Supply COM-PACT	29-03-2021 20.12.2021	pdf 2143.15 KB	
-----------------------	--------------------------	-------------------	--

CAD/CAE-Data

CAD data

2D/3D Models 787-1020	
--------------------------	--

CAE data

EPLAN Data Portal 787-1020	
WSCAD Universe 787-1020	
ZUKEN Portal 787-1020	

1 Compatible Products

1.1 Optional Accessories

1.1.1 Marking

1.1.1.1 Marking strip



Item No.: 210-831

Marking strips; on reel; 2.3 mm wide; plain; Self-adhesive; white

Item No.: 210-832

Marking strips; on reel; 3 mm wide; plain; Self-adhesive; white

1.1.2 Tool

1.1.2.1 Operating tool



Item No.: 210-720

Operating tool; Blade: 3.5 x 0.5 mm; with a partially insulated shaft; multicoloured

Item No.: 210-769

SCREWDRIVER; green

Subject to changes. Please also observe the further product documentation!

Current addresses can be found at: www.wago.com