

# Data Sheet | Item Number: 787-1012

Switched-mode power supply; Compact; 1-phase; 24 VDC output voltage; 2.5 A output current

<https://www.wago.com/787-1012>

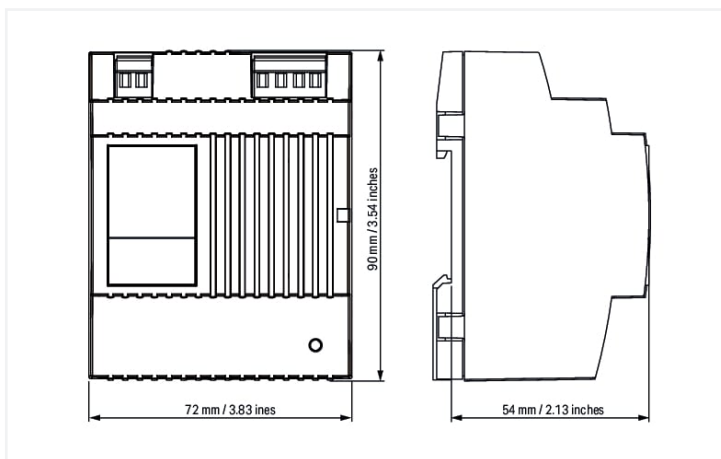
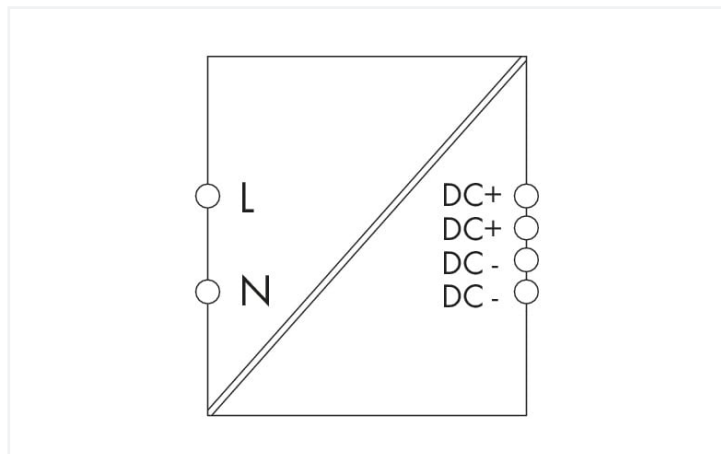

## Features:

- Switched-mode power supply
- Natural convection cooling when horizontally mounted
- Stepped profile, ideal for distribution boards/boxes
- Overhead mounting is possible with derating
- Suitable for both parallel and series operation
- Electrically isolated output voltage (SELV) per EN 61010-2-201/UL 60950-1; PELV per EN 60204

## Technical data

### Input

Phases	1
Nominal input voltage $U_{i,nom}$	1 x AC 100 ... 240 V
Input voltage range	1 x AC 85 ... 264 V; DC 120 ... 300 V
Input voltage derating	$I_o \leq 2 \text{ A}$ (< 100 VAC); $I_o \leq 1.8 \text{ A}$ (< 90 VAC)
Nominal mains frequency range	44 ... 66 Hz; 0 Hz
Input current $I_i$	$\leq 0.6 \text{ A}$ (230 VAC); $\leq 1.4 \text{ A}$ (110 VAC)
Discharge current	$\leq 1 \text{ mA}$
Inrush current	$\leq 30 \text{ A}$ (NTC)
Power factor correction (PFC)	Passive
Mains failure hold-up time	$\geq 80 \text{ ms}$ (230 VAC); $\geq 10 \text{ ms}$ (110 VAC)

### Output

Nominal output voltage $U_{o,nom}$	DC 24 V (SELV)
Output voltage range	DC 22.8 ... 26.4 V (adjustable)
Default setting	DC 24 V
Nominal output current $I_{o,nom}$	2.5 A (24 VDC); 1.6 A (in any mounting position)
Nominal output power	60 W
Deviation	$\leq 2 \%$
Residual ripple	$\leq 100 \text{ mV}$ (peak-to-peak)
Current limitation	$1.1 \times I_{o,nom}$ (typ.)
Overload behavior	Constant current

### Signaling and communication

Signaling	1 x Status indication LED (green)
Operation status indicator	Green LED (U <sub>o</sub> )

### Efficiency/power losses

Power loss P <sub>I</sub>	≤ 2.2 W; ≤ 8.5 W (230 VAC; nominal load)
Power loss (max.) P <sub>I(max)</sub>	10.5 W (100 VAC / 24 VDC; 2.5 A)
Efficiency (typ.)	88 %

### Circuit protection

Internal fuse	T 2 A / 250 VAC
Backup fusing (required)	An external DC fuse is required for the DC input voltage.
Backup fusing (recommended)	Circuit breaker: 6 A (C characteristic), 10 A (B characteristic) or higher

### Safety and protection

Isolation voltage (pri.-sec.)	DC 4.242 kV
Protection class	II
Protection type	IP20; per EN 60529
Resistance to reverse feed	≤ DC 30 V
Overvoltage category	II
Pollution degree	2
Transient suppression (primary)	Varistor
Overvoltage protection; secondary	≤ 40 VDC (in the event of a fault)
Short-circuit-protected	Yes
Open-circuit-proof	Yes
Parallel operation	Yes
Series operation	Yes
MTBF	> 500,000 h (per IEC 61709)

### Connection data

Connection type 1	Input/output
Connection technology	CAGE CLAMP®
WAGO connector	WAGO 740 Series
Solid conductor	0.08 ... 2.5 mm <sup>2</sup> / 28 ... 12 AWG
Fine-stranded conductor	0.08 ... 2.5 mm <sup>2</sup> / 28 ... 12 AWG
Strip length	6 ... 7 mm / 0.24 ... 0.28 inches

### Physical data

Width	72 mm / 2.835 inches
Height	89 mm / 3.504 inches
Depth	59 mm / 2.323 inches
Depth from upper-edge of DIN-rail	55 mm / 2.165 inches

### Mechanical data

Housing design	DIN-rail-mount enclosure
Mounting type	DIN-35 rail

### Material data

Flammability class per UL94	V0
Fire load	0 MJ
Weight	10.9 g

### Environmental requirements

Ambient temperature (operation)	-25 ... +60 °C (Device starts at -40 °C (type-tested))
Ambient temperature (storage)	-25 ... +80 °C
Ambient temperature UL (operation at U <sub>N</sub> )	-25 ... +55 °C
Relative humidity	5 ... 96 % (no condensation permissible)
Derating	-3%/K (> 45°C)
Climatic category	3K3 (per EN 60721)

### Standards and specifications

Conformity marking	CE
Standards/specifications	EN 61010-1 EN 61010-2-201 EN 61204-3 UL 60950-1 UL 508 DNV

### Commercial data

Product Group	6 (INTERFACE ELECTRONIC)
eCl@ss 10.0	27-04-07-01
eCl@ss 9.0	27-04-07-01
ETIM 8.0	EC002540
ETIM 7.0	EC002540
PU (SPU)	1 pcs
Packaging type	Box
Country of origin	CN
GTIN	4050821297598
Customs tariff number	85044083900

### Environmental Product Compliance

RoHS Compliance Status	Compliant, No Exemption
------------------------	-------------------------

### Approvals / Certificates

#### General approvals



Approval	Standard	Certificate Name
EAC GZO Almaty Standart	TP TC 004/2011	EAC CoC 03078
EAC GZO Almaty Standart	TP TC 020/2011	EAC CoC 03081
UL Underwriters Laboratories Inc.	UL 60950-1	E255815
UL Underwriters Laboratories Inc.	UL 508	E255817

#### Declarations of conformity and manufacturer's declarations

Approval	Standard	Certificate Name
EU-Declaration of Confor- mity WAGO GmbH & Co. KG	-	-
UK-Declaration of Confor- mity WAGO GmbH & Co. KG	-	-

Approvals for marine applications



Approval	Standard	Certificate Name
DNV DNV Germany GmbH	DNV-CG-0339, Aug. 2021	TAA00000KT

Downloads

Environmental Product Compliance

Compliance Search
Environmental Product Compliance 787-1012

Documentation

Bid Text			
787-1012	24.06.2019	xml 6.98 KB	
787-1012	12.06.2019	docx 20.75 KB	

Instruction Leaflet			
Power Supply COM-PACT	29-03-2021 20.12.2021	pdf 2143.15 KB	

CAD/CAE-Data

CAD data
2D/3D Models 787-1012

CAE data
EPLAN Data Portal 787-1012
WSCAD Universe 787-1012
ZUKEN Portal 787-1012

1 Compatible Products

1.1 Optional Accessories

1.1.1 Marking

1.1.1.1 Marking strip



[Item No.: 210-831](#)  
Marking strips; on reel; 2.3 mm wide; plain;  
Self-adhesive; white

[Item No.: 210-832](#)  
Marking strips; on reel; 3 mm wide; plain;  
Self-adhesive; white

## 1.1.2 Tool

### 1.1.2.1 Operating tool



**Item No.: 210-720**

Operating tool; Blade: 3.5 x 0.5 mm; with a partially insulated shaft; multicoloured

**Item No.: 210-769**

SCREWDRIVER; green