



AZM 170-11ZRIA-ST-B1 24VAC/DC

- Connector M12, 4-pole
- A- and B-coding of the connectors
- Double-insulated
- Individual coding
- Coding level "High" according to ISO 14119
- 90 mm x 84 mm x 30 mm
- Compact design
- Interlock with protection against incorrect locking.
- Long life
- High holding force
- Particularly suitable for sliding doors

Data

Ordering data

Product type description	AZM 170-11ZRIA-ST-B1 24VAC/DC
Article number (order number)	101144300
EAN (European Article Number)	4030661562308
eCl@ss number, version 12.0	27-27-26-03
eCl@ss number, version 11.0	27-27-26-03
eCl@ss number, version 9.0	27-27-26-03
ETIM number, version 7.0	EC002593
ETIM number, version 6.0	EC002593

Approvals - Standards

Certificates	BG cULus CCC
--------------	--------------------

General data

Standards	BG-GS-ET-19 EN ISO 13849-1 EN ISO 14119 EN IEC 60947-5-1
Coding	Individual coding
Coding level according to EN ISO 14119	High
Working principle	electromechanical
Housing material	Plastic, glass-fibre reinforced thermoplastic, self-extinguishing
Material of the actuator	Stainless steel
Gross weight	278 g

General data - Features

Power to lock	Yes
Number of actuating directions	2
Number of auxiliary contacts	1
Number of safety contacts	1

Safety classification

Standards	EN ISO 13849-1
Performance Level, up to	d
Category	3
Mission time	20 Year(s)

Safety classification - Safety outputs

B _{10D} Normally-closed contact (NC)	2,000,000 Operations
---	----------------------

Safety classification - Fault exclusion

Mission time	20 Year(s)
--------------	------------

Mechanical data

Actuating radius, minimum	140 mm
Mechanical life, minimum	1,000,000 Operations
Holding force F_{Zh} in accordance with EN ISO 14119	1,000 N
Holding force F_{max} , maximum	1,300 N
Latching force	30 N
Positive break travel	11 mm
Positive break force per NC contact, minimum	8.5 N
Positive break force, minimum	8.5 N
Actuating speed, maximum	2 m/s
Mounting	Screws
Type of the fixing screws	2x M5

Mechanical data - Connection technique

Termination	Connector plug M12, 4-pole, (A-coding) Connector plug M12, 4-pole, (B-coding)
-------------	--

Mechanical data - Dimensions

Length of sensor	30 mm
Width of sensor	108 mm
Height of sensor	75.5 mm

Ambient conditions

Degree of protection	IP67
Ambient temperature	-25 ... +60 °C
Storage and transport temperature, minimum	+25 °C

Storage and transport temperature, maximum	+85 °C
Protection class	II

Ambient conditions - Insulation values

Rated insulation voltage U_i	250 VAC
Rated impulse withstand voltage U_{imp}	2.5 kV
Overtoltage category	III
Degree of pollution	3

Electrical data

Thermal test current	4 A
Rated control voltage	24 VAC/DC
Required rated short-circuit current	1,000 A
Electrical power consumption, maximum	10 W
Switching element	NO contact, NC contact
Note (Switching element)	Change-over contact with double break, type Zb or 2 NC or 3 NC or 4 NC contacts, with galvanically separated contact bridges
Switching principle	slow action, positive break NC contact
Switching frequency	1,000 /h
Material of the contacts, electrical	Silver

Electrical data - Magnet control

Magnet switch-on time	100 %
Test pulse duration, maximum	5 ms
Test pulse interval, minimum	50 ms

Electrical data - Safety contacts

Voltage, Utilisation category AC-15	230 VAC
Current, Utilisation category AC-15	4 A
Voltage, Utilisation category DC-13	24 VDC
Current, Utilisation category DC-13	4 A

Electrical data - Auxiliary contacts

Voltage, Utilisation category AC-15	230 VAC
Current, Utilisation category AC-15	4 A
Voltage, Utilisation category DC-13	24 VDC
Current, Utilisation category DC-13	4 A

Other data

Note (applications)	sliding safety guard removable guard hinged safety guard
---------------------	--

Scope of delivery

Scope of delivery	Not available as spare part Slot sealing plugs The actuator is included in the scope of delivery
-------------------	--

Note

Note (General)	The axis of the hinge must be 10 mm above and in a parallel plane to the top surface of the safety switch. minimum actuating radius on rotating guard systems via the narrow edge of the actuator 140 mm minimum actuating radius on hinged guards in line with the plane of the actuator 200 mm The actuator is not available separately.
----------------	---

Ordering code

Product type description:

AZM 170(1)-(2)Z(3)I(4)-(5)-(6)-(7) (8)

(1)

without

Cut clamps

SK

Screw connection

(2)

11

1 NO contacts/1 NC contact

02

2 NC contact

(3)

without

Latching force 5 N

R

Latching force 30 N

I

Individual coding

(4)

without

Power to unlock

A

Power to lock

(5)

without

cable gland

ST

M12 x 1 connector

(6)

B1

with actuator B1

B5

with actuator B5

B6L

with actuator B6L

B6R

with actuator B6R

(7)

without

Manual release

2197	Manual release from side (Standard in case of conector and power to unlock versions)
1637	Gold-plated contacts
(8)	
24VAC/DC	Us 24 VAC/DC
110VAC	Us 110 VAC
230VAC	Us 230 VAC
(1)	
11/11	1 NO contact, 1 NC contact / 1 NO contact 1, NC contact
11/02	1 NO contact, 1 NC contact / 2 NC contacts
12/00	1 NO contact, 2 NC contacts / -
12/11	1 NO contact, 2 NC contact / 1 NO contact 1, NC contact
12/02	1 NO contact, 2 NC contact / 2 NC contacts
02/01	2 NC contacts / 1 NC contact
02/10	2 NC contacts, - / 1 NO contact
(2)	
without	Latching force 5 N
R	Latching force 30 N
(3)	
without	Power to unlock
A	Power to lock
(4)	
B1	with actuator B1
B5	with actuator B5
B6L	with actuator B6L
B6R	with actuator B6R
(5)	

1637

Gold-plated contacts

(6)

2197

Manual release for Power to unlock

Pictures

Product picture (catalogue individual photo)



ID: kazm1fi4

| 611.5 kB | .jpg | 291.042 x 301.625 mm - 825 x 855 px - 72 dpi

| 39.7 kB | .png | 73.731 x 76.553 mm - 209 x 217 px - 72 dpi

| 65.0 kB | .jpg | 119.239 x 123.472 mm - 338 x 350 px - 72 dpi

Dimensional drawing basic component

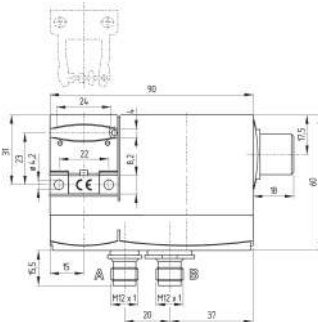

ID: kazm1gi4

| 91.6 kB | .cdr |

| 5.1 kB | .png | 74.083 x 74.083 mm - 210 x 210 px - 72 dpi

| 153.6 kB | .jpg | 352.778 x 353.483 mm - 1000 x 1002 px - 72 dpi

Dimensional drawing actuator

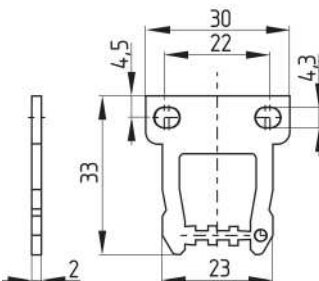

ID: 1az17b03

| 104.1 kB | .jpg | 352.778 x 309.386 mm - 1000 x 877 px - 72 dpi

| 5.4 kB | .png | 74.083 x 64.911 mm - 210 x 184 px - 72 dpi

| 13.8 kB | .png | 50.038 x 43.857 mm - 591 x 518 px - 300 dpi

| 27.1 kB | .jpg | 112.889 x 99.131 mm - 320 x 281 px - 72 dpi

Switch travel diagram

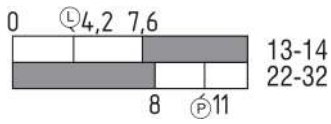

ID: kazm1s02
 | 19.7 kB | .cdr |
 | 2.0 kB | .png | 74.083 x 25.753 mm - 210 x 73 px - 72 dpi
 | 50.1 kB | .jpg | 352.778 x 123.119 mm - 1000 x 349 px - 72 dpi

Diagram

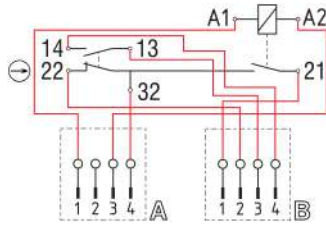

ID: kazm1k21
 | 39.0 kB | .cdr |
 | 133.7 kB | .jpg | 352.778 x 240.947 mm - 1000 x 683 px - 72 dpi
 | 5.5 kB | .png | 74.083 x 50.447 mm - 210 x 143 px - 72 dpi

Schmersal India Pvt. Ltd., Plot No - G-7/1, Ranjangaon MIDC, Tal. - Shirur, Dist.- Pune 412 220

The details and data referred to have been carefully checked. Images may diverge from original. Further technical data can be found in the manual. Technical amendments and errors possible.

Generated on: 11/12/2023, 6:43 am