

# PTTB 1,5/S - Double-level terminal block



3208511

<https://www.phoenixcontact.com/in/products/3208511>

Please be informed that the data shown in this PDF document is generated from our Online Catalog. Please find the complete data in the user documentation. Our General Terms of Use for Downloads are valid.

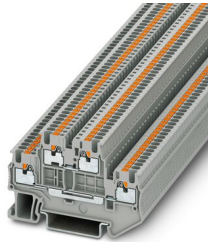

Double-level terminal block, nom. voltage: 500 V, nominal current: 16 A, connection method: Push-in connection, 1st and 2nd level, Rated cross section: 1.5 mm<sup>2</sup>, cross section: 0.14 mm<sup>2</sup> - 1.5 mm<sup>2</sup>, mounting type: NS 35/7,5, NS 35/15, color: gray

## Your advantages

- The Push-in connection terminal blocks are characterized by the system features of the CLIPLINE complete system and by easy and tool-free wiring of conductors with ferrules or solid conductors
- The compact design and front connection enable wiring in a confined space
- In addition to the testing facility in the double function shaft, all terminal blocks provide an additional test connection
- Tested for railway applications

## Commercial Data

Item number	3208511
Packing unit	50 pc
Minimum order quantity	50 pc
Sales Key	BE2
Product Key	BE2214
Catalog Page	Page 39 (C-1-2019)
GTIN	4046356564540
Weight per Piece (including packing)	6.906 g
Weight per Piece (excluding packing)	6.906 g
Customs tariff number	85369010
Country of origin	DE

# PTTB 1,5/S - Double-level terminal block



3208511

<https://www.phoenixcontact.com/in/products/3208511>

## Technical Data

### Product properties

Product type	Multi-level terminal block
Area of application	Railway industry
	Machine building
	Plant engineering
Number of connections	4
Number of rows	2
Potentials	2

### Insulation characteristics

Overvoltage category	III
Degree of pollution	3

### Electrical properties

Rated surge voltage	6 kV
Maximum power dissipation for nominal condition	0.56 W

### Connection data

Number of connections per level	2
Nominal cross section	1.5 mm <sup>2</sup>

### 1st and 2nd level

Stripping length	8 mm ... 10 mm
Internal cylindrical gage	A1 / B1
Connection in acc. with standard	IEC 60947-7-1
Conductor cross section rigid	0.14 mm <sup>2</sup> ... 1.5 mm <sup>2</sup>
Cross section AWG	26 ... 14 (converted acc. to IEC)
Conductor cross section flexible	0.14 mm <sup>2</sup> ... 1.5 mm <sup>2</sup>
Conductor cross section, flexible [AWG]	26 ... 14 (converted acc. to IEC)
Conductor cross-section flexible (ferrule without plastic sleeve)	0.14 mm <sup>2</sup> ... 1.5 mm <sup>2</sup>
Flexible conductor cross section (ferrule with plastic sleeve)	0.14 mm <sup>2</sup> ... 1 mm <sup>2</sup> Using the AI-S 1-8 TQ ferrule, Item No. 1200293, is recommended
Nominal current	16 A
Maximum load current	16 A
Nominal voltage	500 V
Nominal cross section	1.5 mm <sup>2</sup>

### 1st and 2nd level Connection cross sections directly pluggable

Conductor cross section rigid	0.25 mm <sup>2</sup> ... 1.5 mm <sup>2</sup>
Conductor cross-section flexible (ferrule without plastic sleeve)	0.34 mm <sup>2</sup> ... 1.5 mm <sup>2</sup>
Flexible conductor cross section (ferrule with plastic sleeve)	0.34 mm <sup>2</sup> ... 1 mm <sup>2</sup>

## Ex data

# PTTB 1,5/S - Double-level terminal block



3208511

<https://www.phoenixcontact.com/in/products/3208511>

## Rated data (ATEX/IECEX)

Identification	□ II 2 GD Ex eb IIC Gb
Operating temperature range	-60 °C ... 110 °C
Ex-certified accessories	3208579 D-PTTB 1,5/S 3030747 ATP-STTB 4 1204504 SZF 0-0,4X2,5 3022276 CLIPFIX 35-5 3022218 CLIPFIX 35
List of bridges	Plug-in bridge / FBS 2-3,5 / 3213014 Plug-in bridge / FBS 3-3,5 / 3213027 Plug-in bridge / FBS 4-3,5 / 3213030 Plug-in bridge / FBS 5-3,5 / 3213043 Plug-in bridge / FBS 10-3,5 / 3213056 Plug-in bridge / FBS 20-3,5 / 3213069
Bridge data	13.5 A / 1.5 mm <sup>2</sup>
Ex temperature increase	40 K (14.5 A / 1.5 mm <sup>2</sup> )
Rated voltage	352 V
for bridging with bridge	352 V
- At bridging between non-adjacent terminal blocks	220 V
- At bridging between non-adjacent terminal blocks via PE terminal block	220 V
- At cut-to-length bridging	166 V
- At cut-to-length bridging with cover	275 V
- At cut-to-length bridging with partition plate	352 V
Rated insulation voltage	320 V
output	(Permanent)

## Ex level General

Rated current	14.5 A
Maximum load current	14.5 A

## Ex connection data General

Nominal cross section	1.5 mm <sup>2</sup>
Rated cross section AWG	16
Connection capacity rigid	0.14 mm <sup>2</sup> ... 1.5 mm <sup>2</sup>
Connection capacity AWG	26 ... 16
Connection capacity flexible	0.14 mm <sup>2</sup> ... 1.5 mm <sup>2</sup>
Connection capacity AWG	26 ... 16
output	(Permanent)

## Ex level Level 1

Contact resistance	1.4 mΩ
output	(Permanent)

## Ex level Level 2

# PTTB 1,5/S - Double-level terminal block



3208511

<https://www.phoenixcontact.com/in/products/3208511>

Contact resistance	1.3 mΩ
--------------------	--------

## Dimensions

Width	3.5 mm
End cover width	2.2 mm
Height	41.1 mm
Height NS 35/15	50.1 mm
Height NS 35/7,5	42.6 mm
Length	65.4 mm

## Material specifications

Color	gray
Flammability rating according to UL 94	V0
Insulating material group	I
Insulating material	PA
Static insulating material application in cold	-60 °C
Temperature index of insulation material (DIN EN 60216-1 (VDE 0304-21))	130 °C
Relative insulation material temperature index (Elec., UL 746 B)	130 °C
Fire protection for rail vehicles (DIN EN 45545-2) R22	HL 1 - HL 3
Fire protection for rail vehicles (DIN EN 45545-2) R23	HL 1 - HL 3
Fire protection for rail vehicles (DIN EN 45545-2) R24	HL 1 - HL 3
Fire protection for rail vehicles (DIN EN 45545-2) R26	HL 1 - HL 3
Calorimetric heat release NFPA 130 (ASTM E 1354)	28 MJ/kg
Surface flammability NFPA 130 (ASTM E 162)	passed
Specific optical density of smoke NFPA 130 (ASTM E 662)	passed
Smoke gas toxicity NFPA 130 (SMP 800C)	passed

## Electrical tests

### Surge voltage test

Test voltage setpoint	7.3 kV
Result	Test passed

### Temperature-rise test

Requirement temperature-rise test	Increase in temperature $\leq$ 45 K
Result	Test passed
Short-time withstand current 1.5 mm <sup>2</sup>	0.18 kA
Result	Test passed

### Power-frequency withstand voltage

Test voltage setpoint	1.89 kV
Result	Test passed

## Mechanical properties

### Mechanical data

# PTTB 1,5/S - Double-level terminal block



3208511

<https://www.phoenixcontact.com/in/products/3208511>

Open side panel	Yes
-----------------	-----

## Mechanical tests

### Mechanical strength

Result	Test passed
--------	-------------

### Attachment on the carrier

DIN rail/fixing support	NS 35
Test force setpoint	1 N
Result	Test passed

### Test for conductor damage and slackening

Rotation speed	10 rpm
Revolutions	135
Conductor cross section/weight	0.14 mm <sup>2</sup> / 0.2 kg 1.5 mm <sup>2</sup> / 0.4 kg
Result	Test passed

## Environmental and real-life conditions

### Aging

Result	Test passed
--------	-------------

### Needle-flame test

Time of exposure	30 s
Result	Test passed

### Oscillation/broadband noise

Specification	DIN EN 50155 (VDE 0115-200):2008-03
Spectrum	Service life test category 2, bogie-mounted
Frequency	$f_1 = 5 \text{ Hz}$ to $f_2 = 250 \text{ Hz}$
ASD level	6.12 (m/s <sup>2</sup> ) <sup>2</sup> /Hz
Acceleration	3.12g
Test duration per axis	5 h
Test directions	X-, Y- and Z-axis
Result	Test passed

### Shocks

Specification	DIN EN 50155 (VDE 0115-200):2008-03
Pulse shape	Half-sine
Acceleration	30g
Shock duration	18 ms
Number of shocks per direction	3
Test directions	X-, Y- and Z-axis (pos. and neg.)
Result	Test passed

### Ambient conditions

# PTTB 1,5/S - Double-level terminal block



3208511

<https://www.phoenixcontact.com/in/products/3208511>

Ambient temperature (operation)	-60 °C ... 105 °C (max. short-term operating temperature RTI Elec.)
Ambient temperature (storage/transport)	-25 °C ... 60 °C (for a short time, not exceeding 24 h, -60 °C to +70 °C)
Ambient temperature (assembly)	-5 °C ... 70 °C
Ambient temperature (actuation)	-5 °C ... 70 °C
Permissible humidity (storage/transport)	30 % ... 70 %

## Standards and regulations

Connection in acc. with standard	IEC 60947-7-1
----------------------------------	---------------

## Mounting

Mounting type	NS 35/7,5
	NS 35/15

# PTTB 1,5/S - Double-level terminal block



3208511

<https://www.phoenixcontact.com/in/products/3208511>

## Drawings

Circuit diagram

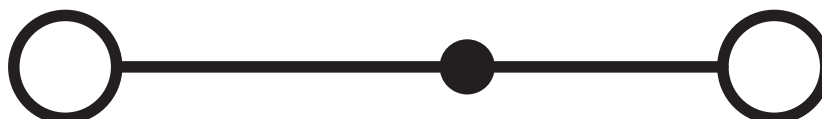

# PTTB 1,5/S - Double-level terminal block





3208511

<https://www.phoenixcontact.com/in/products/3208511>

## Approvals

 <b>CSA</b> Approval ID: 13631				
	Nominal Voltage $U_N$	Nominal Current $I_N$	Cross Section AWG	Cross Section $\text{mm}^2$
Use group B	300 V	15 A	26 - 14	-
Use group C	300 V	15 A	26 - 14	-
Use group D	600 V	5 A	26 - 14	-

 <b>EAC</b> Approval ID: RU C-DE.AI30.B.01102				
---	--	--	--	--

 <b>cULus Recognized</b> Approval ID: E60425				
	Nominal Voltage $U_N$	Nominal Current $I_N$	Cross Section AWG	Cross Section $\text{mm}^2$
Use group B	300 V	15 A	26 - 14	-
Use group C	300 V	15 A	26 - 14	-
Use group D	600 V	5 A	26 - 14	-

 <b>LR</b> Approval ID: LR2371832TA				
---	--	--	--	--

 <b>ClassNK</b> Approval ID: 14ME0912				
---	--	--	--	--

 <b>RS</b> Approval ID: 22.44.01.00083.250				
--	--	--	--	--

 <b>BV</b> Approval ID: 39980/B0 BV				
---	--	--	--	--

 <b>EAC Ex</b> Approval ID: RU C-DE.HA91.B.00066				
--	--	--	--	--



# PTTB 1,5/S - Double-level terminal block



3208511

<https://www.phoenixcontact.com/in/products/3208511>



**IECEX**

Approval ID: IECEX SEV13.0005U



**ATEX**

Approval ID: SEV13ATEX0159U



**CCC**

Approval ID: 2020322313000631



**NEPSI**

Approval ID: GYJ20.1198U



**IECEX**

Approval ID: IECEX SEV13.0005U



**ATEX**

Approval ID: SEV13ATEX0159U



**UKCA-EX**

Approval ID: CML 22UKEX1224U

# PTTB 1,5/S - Double-level terminal block



3208511

<https://www.phoenixcontact.com/in/products/3208511>

## Classifications

### ECLASS

ECLASS-11.0

27141120

### ETIM

ETIM 8.0

EC000897

### UNSPSC

UNSPSC 21.0

39121400

# PTTB 1,5/S - Double-level terminal block



3208511

<https://www.phoenixcontact.com/in/products/3208511>

## Environmental Product Compliance

China RoHS	Environmentally friendly use period: unlimited = EFUP-e
	No hazardous substances above threshold values

# PTTB 1,5/S - Double-level terminal block

3208511

<https://www.phoenixcontact.com/in/products/3208511>

## Accessories

 Note: Applying some accessories below might limit this product.

### FBS 2-3,5 - Plug-in bridge

3213014

<https://www.phoenixcontact.com/in/products/3213014>



Plug-in bridge, pitch: 3.5 mm, number of positions: 2, color: red

 Max. current carrying capacity: 16 A

---

### FBS 3-3,5 - Plug-in bridge

3213027

<https://www.phoenixcontact.com/in/products/3213027>



Plug-in bridge, pitch: 3.5 mm, number of positions: 3, color: red

 Max. current carrying capacity: 16 A

# PTTB 1,5/S - Double-level terminal block

3208511

<https://www.phoenixcontact.com/in/products/3208511>



## FBS 4-3,5 - Plug-in bridge

3213030

<https://www.phoenixcontact.com/in/products/3213030>



Plug-in bridge, pitch: 3.5 mm, number of positions: 4, color: red

 Max. current carrying capacity: 16 A

---

## FBS 5-3,5 - Plug-in bridge

3213043

<https://www.phoenixcontact.com/in/products/3213043>



Plug-in bridge, pitch: 3.5 mm, number of positions: 5, color: red

 Max. current carrying capacity: 16 A

# PTTB 1,5/S - Double-level terminal block

3208511

<https://www.phoenixcontact.com/in/products/3208511>



## FBS 10-3,5 - Plug-in bridge

3213056

<https://www.phoenixcontact.com/in/products/3213056>



Plug-in bridge, pitch: 3.5 mm, number of positions: 10, color: red

 Max. current carrying capacity: 16 A

---

## FBS 20-3,5 - Plug-in bridge

3213069

<https://www.phoenixcontact.com/in/products/3213069>



Plug-in bridge, pitch: 3.5 mm, number of positions: 20, color: red

 Max. current carrying capacity: 16 A

# PTTB 1,5/S - Double-level terminal block

3208511

<https://www.phoenixcontact.com/in/products/3208511>



## FBS 2-3,5 BU - Plug-in bridge

3213086

<https://www.phoenixcontact.com/in/products/3213086>



Plug-in bridge, pitch: 3.5 mm, number of positions: 2, color: blue

 Max. current carrying capacity: 16 A

---

## FBS 3-3,5 BU - Plug-in bridge

3213099

<https://www.phoenixcontact.com/in/products/3213099>



Plug-in bridge, pitch: 3.5 mm, number of positions: 3, color: blue

 Max. current carrying capacity: 16 A

# PTTB 1,5/S - Double-level terminal block

3208511

<https://www.phoenixcontact.com/in/products/3208511>



## FBS 4-3,5 BU - Plug-in bridge

3213109

<https://www.phoenixcontact.com/in/products/3213109>



Plug-in bridge, pitch: 3.5 mm, number of positions: 4, color: blue

 Max. current carrying capacity: 16 A

---

## FBS 5-3,5 BU - Plug-in bridge

3213112

<https://www.phoenixcontact.com/in/products/3213112>



Plug-in bridge, pitch: 3.5 mm, number of positions: 5, color: blue

 Max. current carrying capacity: 16 A



# PTTB 1,5/S - Double-level terminal block

3208511

<https://www.phoenixcontact.com/in/products/3208511>



## FBS 10-3,5 BU - Plug-in bridge

3213125

<https://www.phoenixcontact.com/in/products/3213125>



Plug-in bridge, pitch: 3.5 mm, number of positions: 10, color: blue

 Max. current carrying capacity: 16 A

---

## FBS 20-3,5 BU - Plug-in bridge

3213138

<https://www.phoenixcontact.com/in/products/3213138>

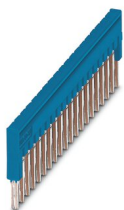

Plug-in bridge, pitch: 3.5 mm, number of positions: 20, color: blue

 Max. current carrying capacity: 16 A

# PTTB 1,5/S - Double-level terminal block

3208511

<https://www.phoenixcontact.com/in/products/3208511>



## FBS 2-3,5 GY - Plug-in bridge

3213153

<https://www.phoenixcontact.com/in/products/3213153>



Plug-in bridge, pitch: 3.5 mm, number of positions: 2, color: gray

 Max. current carrying capacity: 16 A

---

## FBS 3-3,5 GY - Plug-in bridge

3213167

<https://www.phoenixcontact.com/in/products/3213167>



Plug-in bridge, pitch: 3.5 mm, number of positions: 3, color: gray

 Max. current carrying capacity: 16 A

# PTTB 1,5/S - Double-level terminal block

3208511

<https://www.phoenixcontact.com/in/products/3208511>



## FBS 4-3,5 GY - Plug-in bridge

3213180

<https://www.phoenixcontact.com/in/products/3213180>



Plug-in bridge, pitch: 3.5 mm, number of positions: 4, color: gray

 Max. current carrying capacity: 16 A

---

## FBS 5-3,5 GY - Plug-in bridge

3213183

<https://www.phoenixcontact.com/in/products/3213183>



Plug-in bridge, pitch: 3.5 mm, number of positions: 5, color: gray

 Max. current carrying capacity: 16 A

# PTTB 1,5/S - Double-level terminal block

3208511

<https://www.phoenixcontact.com/in/products/3208511>



## FBS 10-3,5 GY - Plug-in bridge

3213196

<https://www.phoenixcontact.com/in/products/3213196>



Plug-in bridge, pitch: 3.5 mm, number of positions: 10, color: gray

 Max. current carrying capacity: 16 A

---

## FBS 20-3,5 GY - Plug-in bridge

3213206

<https://www.phoenixcontact.com/in/products/3213206>



Plug-in bridge, pitch: 3.5 mm, number of positions: 20, color: gray

 Max. current carrying capacity: 16 A

## PTTB 1,5/S - Double-level terminal block

3208511

<https://www.phoenixcontact.com/in/products/3208511>



## FBS 1,5/S-PV - Potential bridge

3216263

<https://www.phoenixcontact.com/in/products/3216263>



Vertical potential bridge, to connect the upper and lower level

---

## SZF 0-0,4X2,5 - Screwdriver

1204504

<https://www.phoenixcontact.com/in/products/1204504>



Actuation tool, for ST terminal blocks, also suitable for use as a bladed screwdriver, size: 0.4 x 2.5 x 75 mm, 2-component grip, with non-slip grip

# PTTB 1,5/S - Double-level terminal block



3208511

<https://www.phoenixcontact.com/in/products/3208511>

## ATP-STTB 4 - Partition plate

3030747

<https://www.phoenixcontact.com/in/products/3030747>

Partition plate, length: 88.7 mm, width: 2 mm, height: 53 mm, color: gray



---

## D-PTTB 1,5/S - End cover

3208579

<https://www.phoenixcontact.com/in/products/3208579>

End cover, length: 65.4 mm, width: 2.2 mm, height: 34.9 mm, color: gray



# PTTB 1,5/S - Double-level terminal block



3208511

<https://www.phoenixcontact.com/in/products/3208511>

## STP 3,5-2 - Marker carriers

0830131

<https://www.phoenixcontact.com/in/products/0830131>



Marker carriers, snaps into the PTTB 1,5/S Push-in double-level terminal block, can be marked with UCT-TM 3,5, UCT-TMF 3,5, ZB 3,5, or ZBF 3,5, gray, unlabeled, mounting type: plug in, lettering field size: 3.5 x 10.5 mm

---

## PT-IL - Mounting material

3208090

<https://www.phoenixcontact.com/in/products/3208090>

Operating decal for the push-in Technology



# PTTB 1,5/S - Double-level terminal block



3208511

<https://www.phoenixcontact.com/in/products/3208511>

## ST-BW 0 - Actuation tool

1200135

<https://www.phoenixcontact.com/in/products/1200135>

Actuation tool, for all 1.5 mm<sup>2</sup> spring cages from PT 1,5/S and FT 1,5/S



---

## D-PTTB 1,5/S-0,8 OG - End cover

1029589

<https://www.phoenixcontact.com/in/products/1029589>

End cover, length: 65.4 mm, width: 0.8 mm, height: 34.9 mm, color: orange





# PTTB 1,5/S - Double-level terminal block

3208511

<https://www.phoenixcontact.com/in/products/3208511>



## AI-S 1 - 8 TQ - Ferrule

1200293

<https://www.phoenixcontact.com/in/products/1200293>



Ferrule, S-Slimline, sleeve length: 8 mm, length: 14.5 mm, color: turquoise

---

## NS 35/ 7,5 PERF 2000MM - DIN rail perforated

0801733

<https://www.phoenixcontact.com/in/products/0801733>



DIN rail perforated, acc. to EN 60715, material: Steel, galvanized, passivated with a thick layer, Standard profile, color: silver, Pack of 25 (50 m)

# PTTB 1,5/S - Double-level terminal block

3208511

<https://www.phoenixcontact.com/in/products/3208511>



## NS 35/ 7,5 UNPERF 2000MM - DIN rail, unperforated

0801681

<https://www.phoenixcontact.com/in/products/0801681>



DIN rail, unperforated, acc. to EN 60715, material: Steel, galvanized, passivated with a thick layer, Standard profile, color: silver, Pack of 25 (50 m)

---

## NS 35/ 7,5 WH PERF 2000MM - DIN rail perforated

1204119

<https://www.phoenixcontact.com/in/products/1204119>



DIN rail perforated, acc. to EN 60715, material: Steel, Galvanized, white passivated, Standard profile, color: silver, Pack of 25 (50 m)

# PTTB 1,5/S - Double-level terminal block

3208511

<https://www.phoenixcontact.com/in/products/3208511>



## NS 35/ 7,5 WH UNPERF 2000MM-VPE 10 - DIN rail, unperforated

1204122

<https://www.phoenixcontact.com/in/products/1204122>



DIN rail, unperforated, acc. to EN 60715, material: Steel, Galvanized, white passivated, Standard profile, color: silver, Pack of 10 (20 m)

---

## NS 35/ 7,5 AL UNPERF 2000MM - DIN rail, unperforated

0801704

<https://www.phoenixcontact.com/in/products/0801704>



DIN rail, unperforated, acc. to EN 60715, material: Aluminum, uncoated, Standard profile, color: silver, Pack of 25 (50 m)

# PTTB 1,5/S - Double-level terminal block

3208511

<https://www.phoenixcontact.com/in/products/3208511>



## NS 35/ 7,5 ZN PERF 2000MM - DIN rail perforated

1206421

<https://www.phoenixcontact.com/in/products/1206421>



DIN rail perforated, acc. to EN 60715, material: Steel, galvanized, Standard profile, color: silver, Pack of 25 (50 m)

---

## NS 35/ 7,5 ZN UNPERF 2000MM - DIN rail, unperforated

1206434

<https://www.phoenixcontact.com/in/products/1206434>



DIN rail, unperforated, acc. to EN 60715, material: Steel, galvanized, Standard profile, color: silver, Pack of 25 (50 m)

# PTTB 1,5/S - Double-level terminal block

3208511

<https://www.phoenixcontact.com/in/products/3208511>



## NS 35/ 7,5 CU UNPERF 2000MM-VPE 10 - DIN rail, unperforated

0801762

<https://www.phoenixcontact.com/in/products/0801762>



DIN rail, unperforated, acc. to EN 60715, material: Copper, uncoated, Standard profile, color: copper-colored, Pack of 10 (20 m)

---

## NS 35/ 7,5 CAP - End cap

1206560

<https://www.phoenixcontact.com/in/products/1206560>

DIN rail end piece, for DIN rail NS 35/7.5



# PTTB 1,5/S - Double-level terminal block

3208511

<https://www.phoenixcontact.com/in/products/3208511>



## NS 35/15 PERF 2000MM - DIN rail perforated

1201730

<https://www.phoenixcontact.com/in/products/1201730>



DIN rail perforated, similar to EN 60715, material: Steel, galvanized, passivated with a thick layer, Standard profile, color: silver, Pack of 25 (50 m)

---

## NS 35/15 UNPERF 2000MM - DIN rail, unperforated

1201714

<https://www.phoenixcontact.com/in/products/1201714>



DIN rail, unperforated, similar to EN 60715, material: Steel, galvanized, passivated with a thick layer, Standard profile, color: silver, Pack of 25 (50 m)

## PTTB 1,5/S - Double-level terminal block

3208511

<https://www.phoenixcontact.com/in/products/3208511>



### NS 35/15 WH PERF 2000MM - DIN rail perforated

0806602

<https://www.phoenixcontact.com/in/products/0806602>



DIN rail perforated, similar to EN 60715, material: Steel, Galvanized, white passivated, Standard profile, color: white, Pack of 25 (50 m)

---

### NS 35/15 WH UNPERF 2000MM-VPE 10 - DIN rail, unperforated

1204135

<https://www.phoenixcontact.com/in/products/1204135>



DIN rail, unperforated, similar to EN 60715, material: Steel, Galvanized, white passivated, Standard profile, color: silver, Pack of 10 (20 m)

# PTTB 1,5/S - Double-level terminal block

3208511

<https://www.phoenixcontact.com/in/products/3208511>



## NS 35/15 AL UNPERF 2000MM - DIN rail, unperforated

1201756

<https://www.phoenixcontact.com/in/products/1201756>



DIN rail, unperforated, similar to EN 60715, material: Aluminum, uncoated, Standard profile, color: silver

---

## NS 35/15 ZN PERF 2000MM - DIN rail perforated

1206599

<https://www.phoenixcontact.com/in/products/1206599>



DIN rail perforated, similar to EN 60715, material: Steel, galvanized, Standard profile, color: silver, Pack of 25 (50 m)



# PTTB 1,5/S - Double-level terminal block

3208511

<https://www.phoenixcontact.com/in/products/3208511>



## NS 35/15 ZN UNPERF 2000MM - DIN rail, unperforated

1206586

<https://www.phoenixcontact.com/in/products/1206586>



DIN rail, unperforated, similar to EN 60715, material: Steel, galvanized, Standard profile, color: silver, Pack of 25 (50 m)

---

## NS 35/15 CU UNPERF 2000MM-VPE 10 - DIN rail, unperforated

1201895

<https://www.phoenixcontact.com/in/products/1201895>



DIN rail, unperforated, similar to EN 60715, material: Copper, uncoated, Standard profile, color: copper-colored, Pack of 10 (20 m)

# PTTB 1,5/S - Double-level terminal block

3208511

<https://www.phoenixcontact.com/in/products/3208511>



## NS 35/15 CAP - End cap

1206573

<https://www.phoenixcontact.com/in/products/1206573>

DIN rail end piece, for DIN rail NS 35/15



---

## NS 35/15-2,3 UNPERF 2000MM-VPE 10 - DIN rail, unperforated

1201798

<https://www.phoenixcontact.com/in/products/1201798>



DIN rail, unperforated, acc. to EN 60715, material: Steel, galvanized, passivated with a thick layer, Standard profile 2.3 mm, color: silver, Pack of 10 (20 m)

## PTTB 1,5/S - Double-level terminal block

3208511

<https://www.phoenixcontact.com/in/products/3208511>



### ZBF 3,5:UNBEDRUCKT - Zack Marker strip, flat

0829392

<https://www.phoenixcontact.com/in/products/0829392>

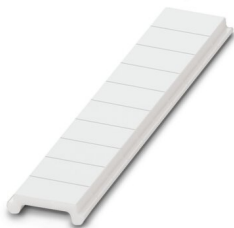

Zack Marker strip, flat, Strip, white, unlabeled, can be labeled with: PLOTMARK, CMS-P1-PLOTTER, mounting type: snapped, for terminal block width: 3.5 mm, lettering field size: 3.5 x 5.2 mm, Number of individual labels: 10

---

### ZBF 3,5 CUS - Zack Marker strip, flat

0829394

<https://www.phoenixcontact.com/in/products/0829394>

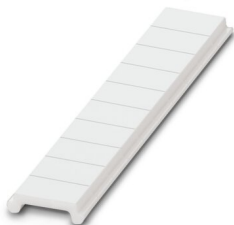

Zack Marker strip, flat, can be ordered: Strip, white, labeled according to customer specifications, mounting type: snap into flat marker groove, for terminal block width: 3.5 mm, lettering field size: 3.5 x 5.2 mm, Number of individual labels: 10

# PTTB 1,5/S - Double-level terminal block

3208511

<https://www.phoenixcontact.com/in/products/3208511>

## ZBF 3,5,LGS:FORTL.ZAHLEN - Zack Marker strip, flat

0801406

<https://www.phoenixcontact.com/in/products/0801406>



Zack Marker strip, flat, Strip, white, labeled, printed horizontally: consecutive numbers 1 ... 10, 11 ... 20, etc. up to 91 ... 100, mounting type: snapped, for terminal block width: 3.5 mm, lettering field size: 5.15 x 3.5 mm, Number of individual labels: 10

---

## ZBF 3,5,QR:FORTL.ZAHLEN - Zack Marker strip, flat

0801407

<https://www.phoenixcontact.com/in/products/0801407>

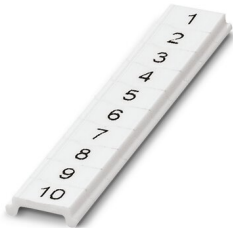

Zack Marker strip, flat, Strip, white, labeled, Printed vertically: consecutive numbers 1 ... 10, 11 ... 20, etc. up to 91 ... 100, mounting type: snapped, for terminal block width: 3.5 mm, lettering field size: 5.15 x 3.5 mm, Number of individual labels: 10

# PTTB 1,5/S - Double-level terminal block

3208511

<https://www.phoenixcontact.com/in/products/3208511>



## UCT-TMF 3,5 - Marker for terminal blocks

0829486

<https://www.phoenixcontact.com/in/products/0829486>



Marker for terminal blocks, Sheet, white, unlabeled, can be labeled with: TOPMARK NEO, TOPMARK LASER, BLUEMARK ID COLOR, BLUEMARK ID, BLUEMARK CLED, THERMOMARK PRIME, THERMOMARK CARD 2.0, THERMOMARK CARD, mounting type: snapped, for terminal block width: 3.5 mm, lettering field size: 2.7 x 4.7 mm, Number of individual labels: 108

---

## UCT-TMF 3,5 CUS - Marker for terminal blocks

0829644

<https://www.phoenixcontact.com/in/products/0829644>



Marker for terminal blocks, can be ordered: by sheet, white, labeled according to customer specifications, mounting type: snap into flat marker groove, for terminal block width: 3.5 mm, lettering field size: 2.7 x 4.7 mm, Number of individual labels: 108

## PTTB 1,5/S - Double-level terminal block

3208511

<https://www.phoenixcontact.com/in/products/3208511>



### MPS-MT - Test plugs

0201744

<https://www.phoenixcontact.com/in/products/0201744>



Test plugs, with solder connection up to 1 mm<sup>2</sup> conductor cross section, number of positions: 1, color: gray

---

### MPS-IH WH - Insulating sleeve

0201663

<https://www.phoenixcontact.com/in/products/0201663>

Insulating sleeve, color: white



# PTTB 1,5/S - Double-level terminal block

3208511

<https://www.phoenixcontact.com/in/products/3208511>



## MPS-IH RD - Insulating sleeve

0201676

<https://www.phoenixcontact.com/in/products/0201676>

Insulating sleeve, color: red



---

## MPS-IH BU - Insulating sleeve

0201689

<https://www.phoenixcontact.com/in/products/0201689>

Insulating sleeve, color: blue

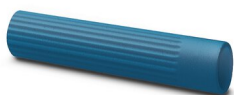

# PTTB 1,5/S - Double-level terminal block

3208511

<https://www.phoenixcontact.com/in/products/3208511>



## MPS-IH YE - Insulating sleeve

0201692

<https://www.phoenixcontact.com/in/products/0201692>

Insulating sleeve, color: yellow



---

## MPS-IH GN - Insulating sleeve

0201702

<https://www.phoenixcontact.com/in/products/0201702>

Insulating sleeve, color: green





# PTTB 1,5/S - Double-level terminal block

3208511

<https://www.phoenixcontact.com/in/products/3208511>



## MPS-IH GY - Insulating sleeve

0201728

<https://www.phoenixcontact.com/in/products/0201728>

Insulating sleeve, color: gray



---

## MPS-IH BK - Insulating sleeve

0201731

<https://www.phoenixcontact.com/in/products/0201731>

Insulating sleeve, color: black



# PTTB 1,5/S - Double-level terminal block



3208511

<https://www.phoenixcontact.com/in/products/3208511>

## PROJECT COMPLETE - Software

1050453

<https://www.phoenixcontact.com/in/products/1050453>



Intuitive planning and marking software for configuring terminal strips and for professional marking of marking materials for terminal blocks, conductors, cables, devices, and systems. The software is available for download

---

## E/UK - End clamp

1201442

<https://www.phoenixcontact.com/in/products/1201442>

End clamp, material: PA, color: gray, Mounting on a DIN rail NS 32 or NS 35



# PTTB 1,5/S - Double-level terminal block

3208511

<https://www.phoenixcontact.com/in/products/3208511>

## E/UK 1 - End clamp

1201413

<https://www.phoenixcontact.com/in/products/1201413>



End clamps, for supporting the ends of double-level and three-level terminal blocks, width: 10 mm, color: gray

---

## CLIPFIX 35 - End clamp

3022218

<https://www.phoenixcontact.com/in/products/3022218>



Quick mounting end clamp for NS 35/7,5 DIN rail or NS 35/15 DIN rail, with marking option, width: 9.5 mm, color: gray

# PTTB 1,5/S - Double-level terminal block

3208511

<https://www.phoenixcontact.com/in/products/3208511>



## CLIPFIX 35-5 - End clamp

3022276

<https://www.phoenixcontact.com/in/products/3022276>



Quick mounting end clamp for NS 35/7,5 DIN rail or NS 35/15 DIN rail, with marking option, with parking option for FBS...5, FBS...6, KSS 5, KSS 6, width: 5.15 mm, color: gray

---

## E/NS 35 N - End clamp

0800886

<https://www.phoenixcontact.com/in/products/0800886>

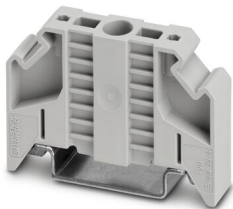

End clamp, width: 9.5 mm, color: gray

# PTTB 1,5/S - Double-level terminal block

3208511

<https://www.phoenixcontact.com/in/products/3208511>



## PS-3,5 - Test plugs

3031010

<https://www.phoenixcontact.com/in/products/3031010>

Test plugs, Modular test plug, number of positions: 1, color: red



---

## DP PS-3,5 - Spacer plate

3031011

<https://www.phoenixcontact.com/in/products/3031011>

Spacer plate, length: 15.9 mm, width: 3.5 mm, height: 33.5 mm, number of positions: 1, color: red



# PTTB 1,5/S - Double-level terminal block

3208511

<https://www.phoenixcontact.com/in/products/3208511>



## PS-3,5/E - Test plugs

3031012

<https://www.phoenixcontact.com/in/products/3031012>



Test plugs, Individual test plug, number of positions: 1, color: red

---

## CRIMPFOX CENTRUS 6S - Crimping pliers

1213144

<https://www.phoenixcontact.com/in/products/1213144>



Crimping pliers, for uninsulated and insulated ferrules, DIN 46228 Part 1 and 4, from 0.14 mm<sup>2</sup> ... 6 mm<sup>2</sup>, also for TWIN ferrules up to 2 x 4 mm<sup>2</sup>, automatic cross section adjustment, lateral insertion, equipped with fall protection

# PTTB 1,5/S - Double-level terminal block

3208511

<https://www.phoenixcontact.com/in/products/3208511>

## CRIMPFOX CENTRUS 10S - Crimping pliers

1213154

<https://www.phoenixcontact.com/in/products/1213154>



Crimping pliers, for uninsulated and insulated ferrules, DIN 46228 Part 1 and 4, from 0.14 mm<sup>2</sup> ... 10 mm<sup>2</sup>, also for TWIN ferrules up to 2 x 4 mm<sup>2</sup>, automatic cross section adjustment, lateral insertion, equipped with fall protection

---

## CRIMPFOX CENTRUS 6H - Crimping pliers

1213146

<https://www.phoenixcontact.com/in/products/1213146>



Crimping pliers, for uninsulated and insulated ferrules, DIN 46228 Part 1 and 4, from 0.14 mm<sup>2</sup> ... 6 mm<sup>2</sup>, also for TWIN ferrules up to 2 x 4 mm<sup>2</sup>, automatic cross section adjustment, lateral insertion, equipped with fall protection

# PTTB 1,5/S - Double-level terminal block

3208511

<https://www.phoenixcontact.com/in/products/3208511>



## CRIMPFOX CENTRUS 10H - Crimping pliers

1213156

<https://www.phoenixcontact.com/in/products/1213156>



Crimping pliers, for uninsulated and insulated ferrules, DIN 46228 Part 1 and 4, from 0.14 mm<sup>2</sup> ... 10 mm<sup>2</sup>, also for TWIN ferrules up to 2 x 4 mm<sup>2</sup>, automatic cross section adjustment, lateral insertion, equipped with fall protection

---

## CRIMPFOX 10S - Crimping pliers

1212045

<https://www.phoenixcontact.com/in/products/1212045>



Crimping pliers, for ferrules without insulating collar according to DIN 46228 Part 1 and ferrules with insulating collar according to DIN 46228 Part 4, 0.14 mm<sup>2</sup> ... 10 mm<sup>2</sup>, unlockable pressure lock, lateral entry



# PTTB 1,5/S - Double-level terminal block

3208511

<https://www.phoenixcontact.com/in/products/3208511>



## CRIMPFOX 6H - Crimping pliers

1212046

<https://www.phoenixcontact.com/in/products/1212046>



Crimping pliers, for ferrules without insulating collar according to DIN 46228 Part 1 and ferrules with insulating collar according to DIN 46228 Part 4, 0.14 mm<sup>2</sup> ... 6 mm<sup>2</sup>, unlockable pressure lock, lateral entry

---

## CRIMPFOX 2,5-M - Crimping pliers

1212719

<https://www.phoenixcontact.com/in/products/1212719>



Crimping pliers, for ferrules without insulating collar according to DIN 46228 Part 1 and ferrules with insulating collar according to DIN 46228 Part 4, 0.25 mm<sup>2</sup> ... 2.5 mm<sup>2</sup>, lateral entry, trapezoidal crimp

# PTTB 1,5/S - Double-level terminal block

3208511

<https://www.phoenixcontact.com/in/products/3208511>

## CRIMPFOX 6-M - Crimping pliers

1212720

<https://www.phoenixcontact.com/in/products/1212720>



Crimping pliers, for ferrules without insulating collar according to DIN 46228 Part 1 and ferrules with insulating collar according to DIN 46228 Part 4, 0.25 mm<sup>2</sup> ... 6.0 mm<sup>2</sup>, lateral entry, trapezoidal crimp

---

## CRIMPFOX 6 - Crimping pliers

1212034

<https://www.phoenixcontact.com/in/products/1212034>



Crimping pliers, for ferrules without insulating collar according to DIN 46228 Part 1 and ferrules with insulating collar according to DIN 46228 Part 4, 0.25 mm<sup>2</sup> ... 6.0 mm<sup>2</sup>, lateral entry, trapezoidal crimp

# PTTB 1,5/S - Double-level terminal block

3208511

<https://www.phoenixcontact.com/in/products/3208511>

## CRIMPFOX 6T - Crimping pliers

1212037

<https://www.phoenixcontact.com/in/products/1212037>



Crimping pliers, for ferrules without insulating collar according to DIN 46228 Part 1 and ferrules with insulating collar according to DIN 46228 Part 4, 0.25 mm<sup>2</sup> ... 6 mm<sup>2</sup>, lateral entry, trapezoidal crimp

---

## CRIMPFOX 6T-F - Crimping pliers

1212038

<https://www.phoenixcontact.com/in/products/1212038>



Crimping pliers, for ferrules without insulating collar according to DIN 46228 Part 1 and ferrules with insulating collar according to DIN 46228 Part 4, 0.25 mm<sup>2</sup> ... 6 mm<sup>2</sup>, front entry, trapezoidal crimp

# PTTB 1,5/S - Double-level terminal block



3208511

<https://www.phoenixcontact.com/in/products/3208511>

## CRIMPFOX 6S-F - Crimping pliers

1212043

<https://www.phoenixcontact.com/in/products/1212043>



Crimping pliers, for ferrules without insulating collar according to DIN 46228 Part 1 and ferrules with insulating collar according to DIN 46228 Part 4, 0.5 mm<sup>2</sup> ... 6 mm<sup>2</sup>, front entry, square crimp

---

## CRIMPFOX-M - Crimping pliers

1212072

<https://www.phoenixcontact.com/in/products/1212072>



Basic pliers, for accommodating dies for a wide range of type of contacts

---

Phoenix Contact 2023 © - all rights reserved  
<https://www.phoenixcontact.com>

PHOENIX CONTACT (I) Pvt. Ltd.  
A-58/2, Okhla Industrial Area, Phase - II, New Delhi-110 020

+91.1275.71420  
[info@phoenixcontact.co.in](mailto:info@phoenixcontact.co.in)