

PPC 6-NS/1-L - COMBI receptacle



3000689

<https://www.phoenixcontact.com/in/products/3000689>

Please be informed that the data shown in this PDF document is generated from our Online Catalog. Please find the complete data in the user documentation. Our General Terms of Use for Downloads are valid.



COMBI receptacle, nom. voltage: 1000 V, nominal current: 41 A, number of connections: 2, number of positions: 1, connection method: Push-in connection, 1 level, Rated cross section: 6 mm², cross section: 0.5 mm² - 10 mm², mounting type: NS 35/15, NS 35/7,5, color: gray

Your advantages

- The Push-in technology COMBI couplings for self-assembly provide solutions that users can implement themselves
- For secure and space-saving accommodation of plug-in contacts in cable ducts and distributor shafts
- Tested for railway applications

Commercial Data

Item number	3000689
Packing unit	50 pc
Minimum order quantity	50 pc
Sales Key	BE2
Product Key	BE2245
Catalog Page	Page 351 (C-1-2019)
GTIN	4046356751827
Weight per Piece (including packing)	9.511 g
Weight per Piece (excluding packing)	9.19 g
Customs tariff number	85366990
Country of origin	PL

PPC 6-NS/1-L - COMBI receptacle



3000689

<https://www.phoenixcontact.com/in/products/3000689>

Technical Data

Product properties

Product type	Terminal coupling
Number of positions	1
Pitch	8.2 mm
Area of application	Railway industry
	Machine building
	Plant engineering
Number of connections	2
Number of rows	1
Potentials	1

Insulation characteristics

Overvoltage category	III
Degree of pollution	3

Electrical properties

Rated surge voltage	8 kV
Maximum power dissipation for nominal condition	1.31 W

Connection data

Nominal cross section	6 mm ²
-----------------------	-------------------

1 level

Stripping length	12 mm
Internal cylindrical gage	A5
Connection in acc. with standard	IEC 61984
Conductor cross section rigid	0.5 mm ² ... 10 mm ²
Cross section AWG	20 ... 8 (converted acc. to IEC)
Conductor cross section flexible	0.5 mm ² ... 6 mm ²
Conductor cross section, flexible [AWG]	20 ... 10 (converted acc. to IEC)
Conductor cross-section flexible (ferrule without plastic sleeve)	0.5 mm ² ... 6 mm ²
Flexible conductor cross section (ferrule with plastic sleeve)	0.5 mm ² ... 6 mm ²
Conductor cross-section flexible (2 conductors with the same cross-section, with TWIN ferrule and plastic sleeve)	0.5 mm ² ... 1.5 mm ²
2 conductors with the same cross section, flexible, with TWIN ferrule with plastic sleeve	0.5 mm ² ... 1.5 mm ²
Nominal current	41 A
Maximum load current	41 A (with 6 mm ² conductor cross section)
Nominal voltage	1000 V
Nominal cross section	6 mm ²

1 level Connection cross sections directly pluggable

Conductor cross section rigid	1 mm ² ... 10 mm ²
-------------------------------	--

PPC 6-NS/1-L - COMBI receptacle



3000689

<https://www.phoenixcontact.com/in/products/3000689>

Conductor cross-section flexible (ferrule without plastic sleeve)	1 mm ² ... 6 mm ²
Flexible conductor cross section (ferrule with plastic sleeve)	1 mm ² ... 6 mm ²

Dimensions

Width	8.2 mm
End cover width	2.2 mm
Height NS 15	38 mm
Height NS 35/15	45.5 mm
Height NS 35/7,5	38 mm
Length	43 mm
Pitch	8.2 mm

Material specifications

Color	gray
Flammability rating according to UL 94	V0
Insulating material group	I
Insulating material	PA
Static insulating material application in cold	-60 °C
Temperature index of insulation material (DIN EN 60216-1 (VDE 0304-21))	125 °C
Relative insulation material temperature index (Elec., UL 746 B)	130 °C
Fire protection for rail vehicles (DIN EN 45545-2) R22	HL 1 - HL 3
Fire protection for rail vehicles (DIN EN 45545-2) R23	HL 1 - HL 3
Fire protection for rail vehicles (DIN EN 45545-2) R24	HL 1 - HL 3
Fire protection for rail vehicles (DIN EN 45545-2) R26	HL 1 - HL 3
Calorimetric heat release NFPA 130 (ASTM E 1354)	27,5 MJ/kg
Surface flammability NFPA 130 (ASTM E 162)	passed
Specific optical density of smoke NFPA 130 (ASTM E 662)	passed
Smoke gas toxicity NFPA 130 (SMP 800C)	passed

Electrical tests

Surge voltage test

Test voltage setpoint	9.8 kV
Result	Test passed
Short-time withstand current 6 mm ²	0.72 kA
Result	Test passed

Power-frequency withstand voltage

Test voltage setpoint	4.26 kV
Result	Test passed

Mechanical properties

Mechanical data

Open side panel	Yes
-----------------	-----

Mechanical tests

Attachment on the carrier

DIN rail/fixing support	NS 35
Test force setpoint	5 N
Result	Test passed
Note	In order to guarantee the leading and lagging PE contact, a PE contact (Art. No. 3000692) has to be installed on the outer positions from and including five positions.

Environmental and real-life conditions

Needle-flame test

Time of exposure	30 s
Result	Test passed

Oscillation/broadband noise

Specification	DIN EN 50155 (VDE 0115-200):2008-03
Spectrum	Service life test category 1, class B, body mounted
Frequency	$f_1 = 5 \text{ Hz}$ to $f_2 = 150 \text{ Hz}$
ASD level	$0.964 \text{ (m/s}^2\text{)}^2\text{/Hz}$
Acceleration	0.58g
Test duration per axis	5 h
Test directions	X-, Y- and Z-axis
Result	Test passed

Shocks

Specification	DIN EN 50155 (VDE 0115-200):2008-03
Pulse shape	Half-sine
Acceleration	5g
Shock duration	30 ms
Number of shocks per direction	3
Test directions	X-, Y- and Z-axis (pos. and neg.)
Result	Test passed

Ambient conditions

Ambient temperature (operation)	-60 °C ... 105 °C (max. short-term operating temperature RTI Elec.)
Ambient temperature (storage/transport)	-25 °C ... 60 °C (for a short time, not exceeding 24 h, -60 °C to +70 °C)
Ambient temperature (assembly)	-5 °C ... 70 °C
Ambient temperature (actuation)	-5 °C ... 70 °C
Permissible humidity (storage/transport)	30 % ... 70 %

Standards and regulations

Connection in acc. with standard	IEC 61984
----------------------------------	-----------

PPC 6-NS/1-L - COMBI receptacle



3000689

<https://www.phoenixcontact.com/in/products/3000689>

Mounting

Mounting type	NS 35/15
	NS 35/7,5
Assembly instructions	Use of a parallel pressing tool is recommended for easy latching of the COMBI connector and coupling elements for self-assembly

PPC 6-NS/1-L - COMBI receptacle

3000689

<https://www.phoenixcontact.com/in/products/3000689>

Drawings

Diagram

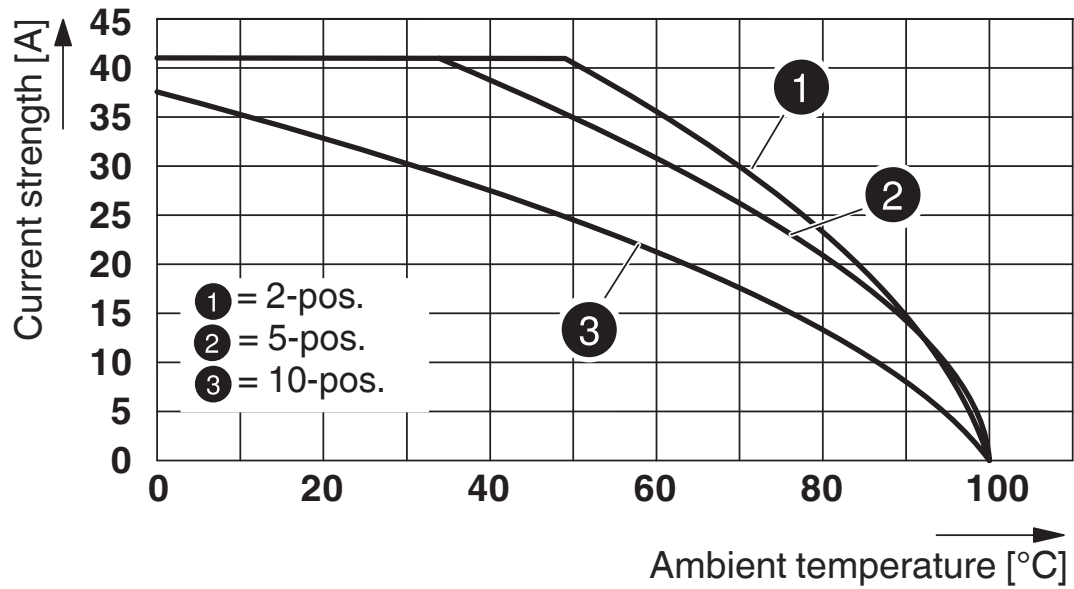

Circuit diagram



PPC 6-NS/1-L - COMBI receptacle



3000689

<https://www.phoenixcontact.com/in/products/3000689>

Approvals

 CSA Approval ID: 13631				
	Nominal Voltage U_N	Nominal Current I_N	Cross Section AWG	Cross Section mm^2
Use group B	600 V	36 A	20 - 8	-
Use group C	600 V	36 A	20 - 8	-

 IECEE CB Scheme Approval ID: DE1-64372_B1_B2				
	Nominal Voltage U_N	Nominal Current I_N	Cross Section AWG	Cross Section mm^2
	1000 V	-	-	-

 EAC Approval ID: RU C-DE.BL08.B.00511				
---	--	--	--	--

 cULus Recognized Approval ID: E60425				
	Nominal Voltage U_N	Nominal Current I_N	Cross Section AWG	Cross Section mm^2
Use group B	600 V	40 A	20 - 8	-
Use group C	600 V	40 A	20 - 8	-

 VDE Zeichengenehmigung Approval ID: 40043445				
	Nominal Voltage U_N	Nominal Current I_N	Cross Section AWG	Cross Section mm^2
	1000 V	-	-	0.5 - 6

PPC 6-NS/1-L - COMBI receptacle



3000689

<https://www.phoenixcontact.com/in/products/3000689>

Classifications

ECLASS

ECLASS-11.0	27141151
ECLASS-12.0	27141151
ECLASS-13.0	27250306

ETIM

ETIM 8.0	EC002021
----------	----------

UNSPSC

UNSPSC 21.0	39121400
-------------	----------

PPC 6-NS/1-L - COMBI receptacle



3000689

<https://www.phoenixcontact.com/in/products/3000689>

Environmental Product Compliance

China RoHS	Environmentally friendly use period: unlimited = EFUP-e
	No hazardous substances above threshold values

PPC 6-NS/1-L - COMBI receptacle



3000689

<https://www.phoenixcontact.com/in/products/3000689>

Mandatory Accessories

PP-H 6/ 1 - Plug

3061541

<https://www.phoenixcontact.com/in/products/3061541>



Plug, nom. voltage: 1000 V, nominal current: 41 A, number of connections: 1, number of positions: 1, connection method: Push-in connection, 1 level, Rated cross section: 6 mm², cross section: 0.5 mm² - 10 mm², color: gray

PP-H 6/ 1 BU - Plug

3061554

<https://www.phoenixcontact.com/in/products/3061554>



Plug, nom. voltage: 1000 V, nominal current: 41 A, number of connections: 1, number of positions: 1, connection method: Push-in connection, 1 level, Rated cross section: 6 mm², cross section: 0.5 mm² - 10 mm², color: blue

PPC 6-NS/1-L - COMBI receptacle

3000689

<https://www.phoenixcontact.com/in/products/3000689>

PP-H 6/ 1 GNYE - Plug

3061567

<https://www.phoenixcontact.com/in/products/3061567>



Plug, nom. voltage: 1000 V, nominal current: 41 A, number of connections: 1, number of positions: 1, connection method: Push-in connection, 1 level, Rated cross section: 6 mm², cross section: 0.5 mm² - 10 mm², color: green-yellow

PP-H 6/10 - Plug

3061651

<https://www.phoenixcontact.com/in/products/3061651>



Plug, nom. voltage: 1000 V, nominal current: 41 A, number of connections: 10, number of positions: 10, connection method: Push-in connection, 1 level, Rated cross section: 6 mm², cross section: 0.5 mm² - 10 mm², color: gray

PPC 6-NS/1-L - COMBI receptacle

3000689

<https://www.phoenixcontact.com/in/products/3000689>

PP-H 6/ 1-L - Plug

3061664

<https://www.phoenixcontact.com/in/products/3061664>



Plug, for self-assembly, nom. voltage: 1000 V, nominal current: 41 A, number of connections: 1, number of positions: 1, connection method: Push-in connection, 1 level, Rated cross section: 6 mm², cross section: 0.5 mm² - 10 mm², color: gray

PP-H 6/ 1-L BU - Plug

3061677

<https://www.phoenixcontact.com/in/products/3061677>



Plug, for self-assembly, nom. voltage: 1000 V, nominal current: 41 A, number of connections: 1, number of positions: 1, connection method: Push-in connection, 1 level, Rated cross section: 6 mm², cross section: 0.5 mm² - 10 mm², color: blue

PPC 6-NS/1-L - COMBI receptacle

3000689

<https://www.phoenixcontact.com/in/products/3000689>

PP-H 6/ 1-L GNYE - Plug

3061680

<https://www.phoenixcontact.com/in/products/3061680>



Plug, for self-assembly, nom. voltage: 1000 V, nominal current: 41 A, number of connections: 1, number of positions: 1, connection method: Push-in connection, 1 level, Rated cross section: 6 mm², cross section: 0.5 mm² - 10 mm², color: green/yellow

PP-H 6/ 1-M - Plug

3061693

<https://www.phoenixcontact.com/in/products/3061693>



Plug, for self-assembly, nom. voltage: 1000 V, nominal current: 41 A, number of connections: 1, number of positions: 1, connection method: Push-in connection, 1 level, Rated cross section: 6 mm², cross section: 0.5 mm² - 10 mm², color: gray

PPC 6-NS/1-L - COMBI receptacle

3000689

<https://www.phoenixcontact.com/in/products/3000689>

PP-H 6/ 1-M BU - Plug

3061703

<https://www.phoenixcontact.com/in/products/3061703>



Plug, for self-assembly, nom. voltage: 1000 V, nominal current: 41 A, number of connections: 1, number of positions: 1, connection method: Push-in connection, 1 level, Rated cross section: 6 mm², cross section: 0.5 mm² - 10 mm², color: blue

PP-H 6/ 1-M GNYE - Plug

3061716

<https://www.phoenixcontact.com/in/products/3061716>



Plug, for self-assembly, nom. voltage: 1000 V, nominal current: 41 A, number of connections: 1, number of positions: 1, connection method: Push-in connection, 1 level, Rated cross section: 6 mm², cross section: 0.5 mm² - 10 mm², color: green/yellow

PPC 6-NS/1-L - COMBI receptacle

3000689

<https://www.phoenixcontact.com/in/products/3000689>

PP-H 6/ 1-R - Plug

3061729

<https://www.phoenixcontact.com/in/products/3061729>



Plug, for self-assembly, nom. voltage: 1000 V, nominal current: 41 A, number of connections: 1, number of positions: 1, connection method: Push-in connection, 1 level, Rated cross section: 6 mm², cross section: 0.5 mm² - 10 mm², color: gray

PP-H 6/ 1-R BU - Plug

3061732

<https://www.phoenixcontact.com/in/products/3061732>



Plug, for self-assembly, nom. voltage: 1000 V, nominal current: 41 A, number of connections: 1, number of positions: 1, connection method: Push-in connection, 1 level, Rated cross section: 6 mm², cross section: 0.5 mm² - 10 mm², color: blue

PPC 6-NS/1-L - COMBI receptacle

3000689

<https://www.phoenixcontact.com/in/products/3000689>

PP-H 6/ 1-R GNYE - Plug

3061745

<https://www.phoenixcontact.com/in/products/3061745>



Plug, for self-assembly, nom. voltage: 1000 V, nominal current: 41 A, number of connections: 1, number of positions: 1, connection method: Push-in connection, 1 level, Rated cross section: 6 mm², cross section: 0.5 mm² - 10 mm², color: green/yellow

PP-H 6/ 2 - Plug

3061570

<https://www.phoenixcontact.com/in/products/3061570>



Plug, nom. voltage: 1000 V, nominal current: 41 A, number of connections: 2, number of positions: 2, connection method: Push-in connection, 1 level, Rated cross section: 6 mm², cross section: 0.5 mm² - 10 mm², color: gray

PPC 6-NS/1-L - COMBI receptacle

3000689

<https://www.phoenixcontact.com/in/products/3000689>

PP-H 6/ 3 - Plug

3061583

<https://www.phoenixcontact.com/in/products/3061583>



Plug, nom. voltage: 1000 V, nominal current: 41 A, number of connections: 3, number of positions: 3, connection method: Push-in connection, 1 level, Rated cross section: 6 mm², cross section: 0.5 mm² - 10 mm², color: gray

PP-H 6/ 4 - Plug

3061596

<https://www.phoenixcontact.com/in/products/3061596>



Plug, nom. voltage: 1000 V, nominal current: 41 A, number of connections: 4, number of positions: 4, connection method: Push-in connection, 1 level, Rated cross section: 6 mm², cross section: 0.5 mm² - 10 mm², color: gray

PPC 6-NS/1-L - COMBI receptacle

3000689

<https://www.phoenixcontact.com/in/products/3000689>

PP-H 6/ 5 - Plug

3061606

<https://www.phoenixcontact.com/in/products/3061606>



Plug, nom. voltage: 1000 V, nominal current: 41 A, number of connections: 5, number of positions: 5, connection method: Push-in connection, 1 level, Rated cross section: 6 mm², cross section: 0.5 mm² - 10 mm², color: gray

PP-H 6/ 6 - Plug

3061619

<https://www.phoenixcontact.com/in/products/3061619>



Plug, nom. voltage: 1000 V, nominal current: 41 A, number of connections: 6, number of positions: 6, connection method: Push-in connection, 1 level, Rated cross section: 6 mm², cross section: 0.5 mm² - 10 mm², color: gray

PPC 6-NS/1-L - COMBI receptacle

3000689

<https://www.phoenixcontact.com/in/products/3000689>

PP-H 6/ 7 - Plug

3061622

<https://www.phoenixcontact.com/in/products/3061622>



Plug, nom. voltage: 1000 V, nominal current: 41 A, number of connections: 7, number of positions: 7, connection method: Push-in connection, 1 level, Rated cross section: 6 mm², cross section: 0.5 mm² - 10 mm², color: gray

PP-H 6/ 8 - Plug

3061635

<https://www.phoenixcontact.com/in/products/3061635>



Plug, nom. voltage: 1000 V, nominal current: 41 A, number of connections: 8, number of positions: 8, connection method: Push-in connection, 1 level, Rated cross section: 6 mm², cross section: 0.5 mm² - 10 mm², color: gray

PPC 6-NS/1-L - COMBI receptacle

3000689

<https://www.phoenixcontact.com/in/products/3000689>



PP-H 6/ 9 - Plug

3061648

<https://www.phoenixcontact.com/in/products/3061648>



Plug, nom. voltage: 1000 V, nominal current: 41 A, number of connections: 9, number of positions: 9, connection method: Push-in connection, 1 level, Rated cross section: 6 mm², cross section: 0.5 mm² - 10 mm², color: gray

PZ/2 - Strain relief

3040627

<https://www.phoenixcontact.com/in/products/3040627>



Strain relief, length: 48.7 mm, width: 9.3 mm, number of positions: 2, color: black

PPC 6-NS/1-L - COMBI receptacle

3000689

<https://www.phoenixcontact.com/in/products/3000689>



PPC 6/1-L - COMBI receptacle

3000690

<https://www.phoenixcontact.com/in/products/3000690>



COMBI receptacle, nom. voltage: 1000 V, nominal current: 41 A, number of connections: 2, number of positions: 1, connection method: Push-in connection, 1 level, Rated cross section: 6 mm², cross section: 0.5 mm² - 10 mm², color: gray

PPC 6/1-L BU - COMBI receptacle

3000691

<https://www.phoenixcontact.com/in/products/3000691>



COMBI receptacle, nom. voltage: 1000 V, nominal current: 41 A, number of connections: 2, number of positions: 1, connection method: Push-in connection, 1 level, Rated cross section: 6 mm², cross section: 0.5 mm² - 10 mm², color: blue

PPC 6-NS/1-L - COMBI receptacle

3000689

<https://www.phoenixcontact.com/in/products/3000689>



PPC 6/1-L GNYE - COMBI receptacle

3000692

<https://www.phoenixcontact.com/in/products/3000692>



COMBI receptacle, nom. voltage: 1000 V, nominal current: 41 A, number of connections: 2, number of positions: 1, connection method: Push-in connection, 1 level, Rated cross section: 6 mm², cross section: 0.5 mm² - 10 mm², color: green/yellow

Accessories

D-PPC 6 - End cover

3000703

<https://www.phoenixcontact.com/in/products/3000703>

End cover, length: 47 mm, width: 2.2 mm, height: 24.7 mm, color: gray



PPC 6-NS/1-L - COMBI receptacle

3000689

<https://www.phoenixcontact.com/in/products/3000689>



SZF 2-0,8X4,0 - Screwdriver

1204520

<https://www.phoenixcontact.com/in/products/1204520>



Actuation tool, for ST terminal blocks, also suitable for use as a bladed screwdriver, size: 0.8 x 4.0 x 100 mm, 2-component grip, with non-slip grip

PC - Coding star

3040588

<https://www.phoenixcontact.com/in/products/3040588>



Coding star, length: 3 mm, width: 3 mm, height: 6 mm, color: red

PPC 6-NS/1-L - COMBI receptacle



3000689

<https://www.phoenixcontact.com/in/products/3000689>

ZBF 8:UNBEDRUCKT - Zack Marker strip, flat

0808781

<https://www.phoenixcontact.com/in/products/0808781>



Zack Marker strip, flat, Strip, white, unlabeled, can be labeled with: PLOTMARK, CMS-P1-PLOTTER, mounting type: snapped, for terminal block width: 8 mm, lettering field size: 5.15 x 8.15 mm, Number of individual labels: 10

ZBF 8 CUS - Zack Marker strip, flat

0825030

<https://www.phoenixcontact.com/in/products/0825030>



Zack Marker strip, flat, can be ordered: Strip, white, labeled according to customer specifications, mounting type: snap into flat marker groove, for terminal block width: 8 mm, lettering field size: 5.15 x 8.15 mm, Number of individual labels: 10

PPC 6-NS/1-L - COMBI receptacle

3000689

<https://www.phoenixcontact.com/in/products/3000689>



ZBF 8,LGS:FORTL.ZAHLEN - Zack Marker strip, flat

0808804

<https://www.phoenixcontact.com/in/products/0808804>



Zack Marker strip, flat, Strip, white, labeled, printed horizontally: consecutive numbers 1 ... 10, 11 ... 20, etc. up to 101 ... 110, mounting type: snapped, for terminal block width: 8 mm, lettering field size: 5.15 x 8.15 mm, Number of individual labels: 10

UC-TMF 8 - Marker for terminal blocks

0818137

<https://www.phoenixcontact.com/in/products/0818137>



Marker for terminal blocks, Sheet, white, unlabeled, can be labeled with: BLUEMARK ID COLOR, BLUEMARK ID, BLUEMARK CLED, PLOTMARK, CMS-P1-PLOTTER, mounting type: snapped, for terminal block width: 8.2 mm, lettering field size: 7.6 x 5.1 mm, Number of individual labels: 56

PPC 6-NS/1-L - COMBI receptacle

3000689

<https://www.phoenixcontact.com/in/products/3000689>



UC-TMF 8 CUS - Marker for terminal blocks

0824654

<https://www.phoenixcontact.com/in/products/0824654>



Marker for terminal blocks, can be ordered: by sheet, white, labeled according to customer specifications, mounting type: snap into flat marker groove, for terminal block width: 8.2 mm, lettering field size: 7.6 x 5.1 mm, Number of individual labels: 56

UCT-TMF 8 - Marker for terminal blocks

0828748

<https://www.phoenixcontact.com/in/products/0828748>



Marker for terminal blocks, Sheet, white, unlabeled, can be labeled with: TOPMARK NEO, TOPMARK LASER, BLUEMARK ID COLOR, BLUEMARK ID, BLUEMARK CLED, THERMOMARK PRIME, THERMOMARK CARD 2.0, THERMOMARK CARD, mounting type: snapped, for terminal block width: 8.2 mm, lettering field size: 7.4 x 4.7 mm, Number of individual labels: 42

PPC 6-NS/1-L - COMBI receptacle

3000689

<https://www.phoenixcontact.com/in/products/3000689>



UCT-TMF 8 CUS - Marker for terminal blocks

0829672

<https://www.phoenixcontact.com/in/products/0829672>



Marker for terminal blocks, can be ordered: by sheet, white, labeled according to customer specifications, mounting type: snap into flat marker groove, for terminal block width: 8.2 mm, lettering field size: 7.4 x 4.7 mm, Number of individual labels: 42

MPS-MT - Test plugs

0201744

<https://www.phoenixcontact.com/in/products/0201744>



Test plugs, with solder connection up to 1 mm² conductor cross section, number of positions: 1, color: gray

PPC 6-NS/1-L - COMBI receptacle

3000689

<https://www.phoenixcontact.com/in/products/3000689>



MPS-IH WH - Insulating sleeve

0201663

<https://www.phoenixcontact.com/in/products/0201663>

Insulating sleeve, color: white



MPS-IH RD - Insulating sleeve

0201676

<https://www.phoenixcontact.com/in/products/0201676>

Insulating sleeve, color: red



PPC 6-NS/1-L - COMBI receptacle

3000689

<https://www.phoenixcontact.com/in/products/3000689>



MPS-IH BU - Insulating sleeve

0201689

<https://www.phoenixcontact.com/in/products/0201689>

Insulating sleeve, color: blue

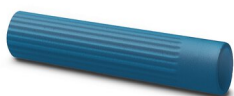

MPS-IH YE - Insulating sleeve

0201692

<https://www.phoenixcontact.com/in/products/0201692>

Insulating sleeve, color: yellow



PPC 6-NS/1-L - COMBI receptacle

3000689

<https://www.phoenixcontact.com/in/products/3000689>



MPS-IH GN - Insulating sleeve

0201702

<https://www.phoenixcontact.com/in/products/0201702>

Insulating sleeve, color: green



MPS-IH GY - Insulating sleeve

0201728

<https://www.phoenixcontact.com/in/products/0201728>

Insulating sleeve, color: gray



PPC 6-NS/1-L - COMBI receptacle

3000689

<https://www.phoenixcontact.com/in/products/3000689>



MPS-IH BK - Insulating sleeve

0201731

<https://www.phoenixcontact.com/in/products/0201731>

Insulating sleeve, color: black



PROJECT COMPLETE - Software

1050453

<https://www.phoenixcontact.com/in/products/1050453>



Intuitive planning and marking software for configuring terminal strips and for professional marking of marking materials for terminal blocks, conductors, cables, devices, and systems. The software is available for download

PPC 6-NS/1-L - COMBI receptacle



3000689

<https://www.phoenixcontact.com/in/products/3000689>

E/UK - End clamp

1201442

<https://www.phoenixcontact.com/in/products/1201442>

End clamp, material: PA, color: gray, Mounting on a DIN rail NS 32 or NS 35



E/UK 1 - End clamp

1201413

<https://www.phoenixcontact.com/in/products/1201413>

End clamps, for supporting the ends of double-level and three-level terminal blocks, width: 10 mm, color: gray



Phoenix Contact 2023 © - all rights reserved
<https://www.phoenixcontact.com>

PHOENIX CONTACT (I) Pvt. Ltd.
A-58/2, Okhla Industrial Area, Phase - II, New Delhi-110 020

+91.1275.71420
info@phoenixcontact.co.in