

HC-STA-B16-BWD-ELC-AL - Housing



1411327

<https://www.phoenixcontact.com/in/products/1411327>

Please be informed that the data shown in this PDF document is generated from our online catalog. Please find the complete data in the user documentation. Our general terms of use for downloads are valid.



HEAVYCON B16 panel mounting base, with double locking latch, with flat gasket, salt-water-resistant aluminum, conductive profile gasket

Your advantages

- Good shielding in the event of electromagnetic interference

Commercial data

Item number	1411327
Packing unit	1 pc
Minimum order quantity	1 pc
Sales key	BF7
Product key	BF7APB
Catalog page	Page 623 (C-2-2019)
GTIN	4046356927475
Weight per piece (including packing)	118.8 g
Weight per piece (excluding packing)	113 g
Customs tariff number	85389099
Country of origin	CN

HC-STA-B16-BWD-ELC-AL - Housing



1411327

<https://www.phoenixcontact.com/in/products/1411327>

Technical data

Notes

General	For contact inserts HC-B16, BB32, D40, DD72, HS6, M, K
General	also available as a powder-coated or color version: 1373288 HC-STA-B16-BWD-EL/.../...

Product properties

Product type	Housing with locking latch
Housing type	Panel mounting base
Application	Standard
Type	B16
Pg screw connection	none

Data management status

Article revision	02
------------------	----

Dimensions

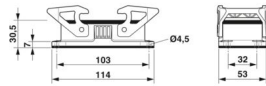
Dimensional drawing	
Width	53 mm
Height	30.5 mm
Length	114 mm
Drill hole distance, horizontal	103 mm
Drill hole distance, vertical	32 mm
Hole diameter	4.5 mm

Installation dimensions

Width of the assembly cutout	35 mm
Length of the assembly cutout	86 mm

Material specifications

Flammability rating according to UL 94	V0 (Interlock)
Seal material	NBR, conductive NBR, conductive
Housing material	Die-cast aluminum, salt water resistant
Housing surface material	uncoated
Locking latch material	Polyamide

Mechanical properties

Mechanical data

Locking type	Latch
--------------	-------

HC-STA-B16-BWD-ELC-AL - Housing



1411327

<https://www.phoenixcontact.com/in/products/1411327>

Connection data

Tightening torque	0.8 Nm ... 1.2 Nm (For M4 mounting screws on the panel-mount base)
-------------------	--

Environmental and real-life conditions

Ambient conditions

Degree of protection	IP66
	IP67
Enclosure rating (NEMA)	4 (UL 50e)
	4X (UL 50e)
	12 (UL 50e)
Impact strength	IK09
Ambient temperature (operation)	-40 °C ... 125 °C

HC-STA-B16-BWD-ELC-AL - Housing



1411327

<https://www.phoenixcontact.com/in/products/1411327>

Drawings

Dimensional drawing

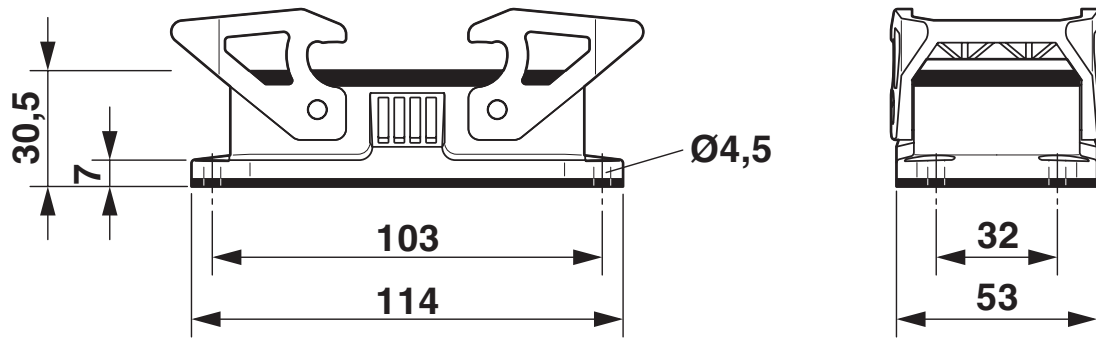

Dimensional drawing

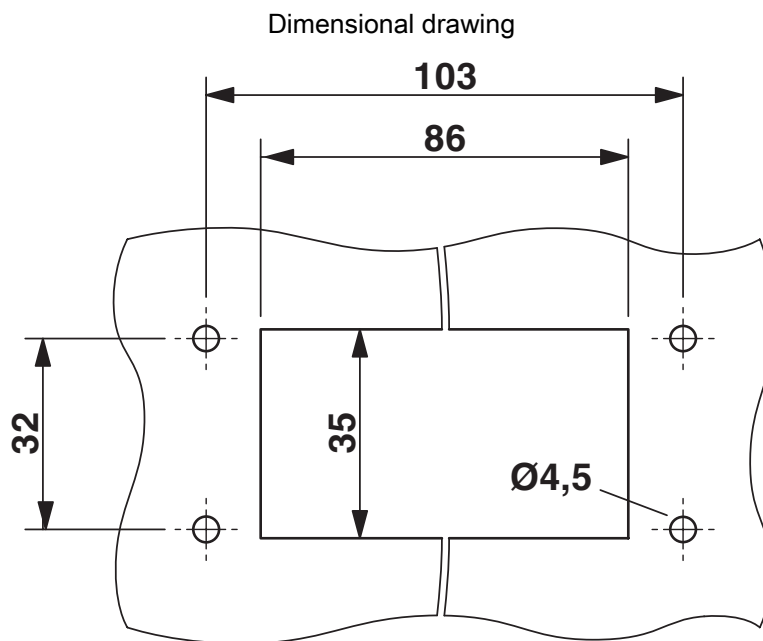

Mounting cutout

1411327

<https://www.phoenixcontact.com/in/products/1411327>

Approvals

To download certificates, visit the product detail page: <https://www.phoenixcontact.com/in/products/1411327>

DNV

Approval ID: TAE000037S



cUL Recognized

Approval ID: E255026



UL Recognized

Approval ID: E255026



EAC

Approval ID: RU C-DE.BL08.B.00511

cULus Recognized

HC-STA-B16-BWD-ELC-AL - Housing



1411327

<https://www.phoenixcontact.com/in/products/1411327>

Classifications

ECLASS

ECLASS-11.0	27440202
ECLASS-12.0	27440202
ECLASS-13.0	27440202

ETIM

ETIM 9.0	EC000437
----------	----------

UNSPSC

UNSPSC 21.0	31261500
-------------	----------

1411327

<https://www.phoenixcontact.com/in/products/1411327>

Environmental product compliance

EU RoHS

Fulfills EU RoHS substance requirements	Yes, No exemptions
---	--------------------

China RoHS

Environment friendly use period (EFUP)	EFUP-E
	No hazardous substances above the limits

EU REACH SVHC

REACH candidate substance (CAS No.)	No substance above 0.1 wt%
-------------------------------------	----------------------------

HC-STA-B16-BWD-ELC-AL - Housing



1411327

<https://www.phoenixcontact.com/in/products/1411327>

Accessories

HC-B16-SG-CBK - Flat gasket

1411485

<https://www.phoenixcontact.com/in/products/1411485>



Replacement flat gasket, for HEAVYCON panel mounting base, HC-STA....AL, type B16, conductive

HC-B16-SP-CBK - Profile gasket

1411480

<https://www.phoenixcontact.com/in/products/1411480>



Profile gasket for HEAVYCON EVO supporting base element type B16, conductive

HC-STA-B16-BWD-ELC-AL - Housing

1411327

<https://www.phoenixcontact.com/in/products/1411327>

HC-STA-B10-24-DL-PLBK - Housing brackets

1412886

<https://www.phoenixcontact.com/in/products/1412886>



Double locking latch for B10 / B16 / B24 housing, HC-EVO...AL and HC-STA...AL

HC-B16-BCFD-P-BK - Protective cover

1346539

<https://www.phoenixcontact.com/in/products/1346539>



Protective cover B16, for double locking latch, protective cover material: PC, height: 26.4 mm, seal: no

HC-STA-B16-BWD-ELC-AL - Housing



1411327

<https://www.phoenixcontact.com/in/products/1411327>

US-EMLP-HA (20X9) - Plastic label

0830989

<https://www.phoenixcontact.com/in/products/0830989>



Plastic label, Card, white, unlabeled, can be labeled with: BLUEMARK ID COLOR, BLUEMARK ID, THERMOMARK PRIME, THERMOMARK CARD 2.0, THERMOMARK CARD, mounting type: adhesive, lettering field size: 20 x 9 mm, Number of individual labels: 70

US-EMLP-HA (20X9) CUS - Plastic label

0830995

<https://www.phoenixcontact.com/in/products/0830995>



Plastic label, Card, can be ordered: by card, white, labeled, can be labeled with: THERMOMARK CARD, mounting type: adhesive, lettering field size: 20 x 9 mm, Number of individual labels: 70

HC-STA-B16-BWD-ELC-AL - Housing

1411327

<https://www.phoenixcontact.com/in/products/1411327>



HC-STA-B16-DC-PL - Protective cover

1421102

<https://www.phoenixcontact.com/in/products/1421102>



Protective cover, design: B16

Phoenix Contact 2024 © - all rights reserved

<https://www.phoenixcontact.com>

PHOENIX CONTACT (I) Pvt. Ltd.

A-58/2, Okhla Industrial Area, Phase - II, New Delhi-110 020

+91.1275.71420

info@phoenixcontact.co.in