



SERIES 71 ALUMINUM EXTRACTOR

MATERIALS AND FINISH

Material:

6061-T6 Aluminum alloy per QQ-A-250/8

Finish:

Customer specified

WEIGHT

Aluminum: .05 oz. (1.42 g)

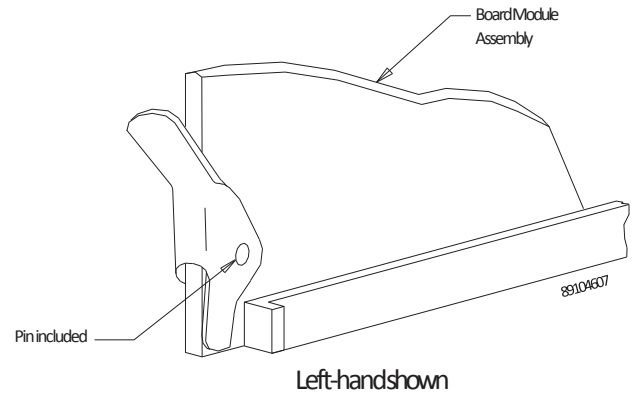

APPLICATION DATA

Two (2) extractors are recommended per board.
 (One "L" and one "R" per printed circuit board).
 Provides extraction travel of 11.4 (.45) minimum,
 with a mechanical advantage of 4.5:1

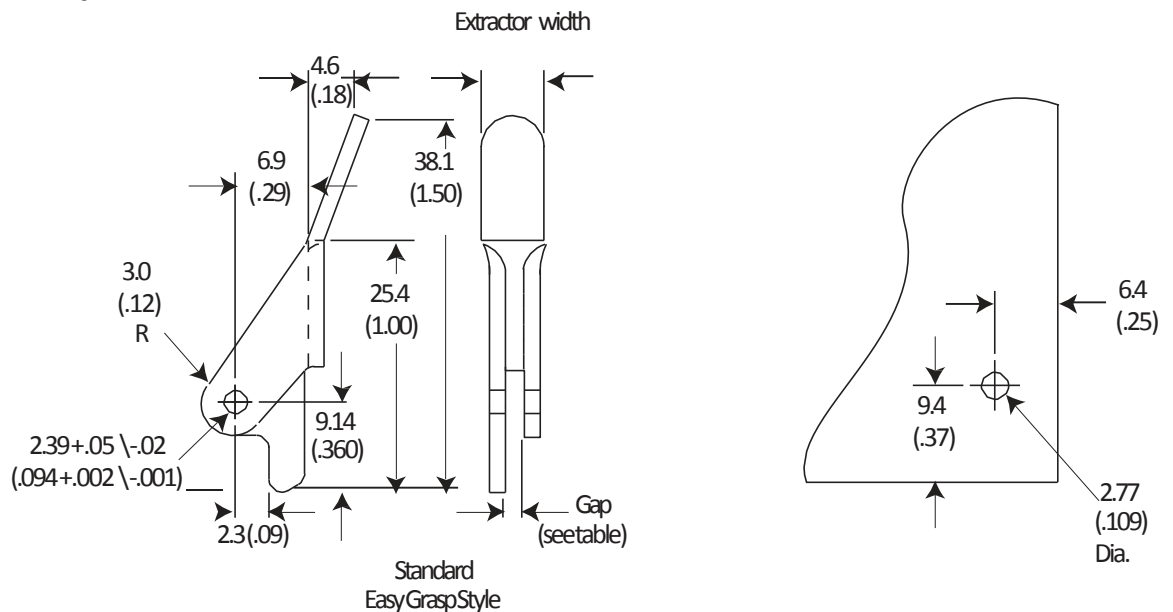

SERIES 71 ALUMINUM EXTRACTOR

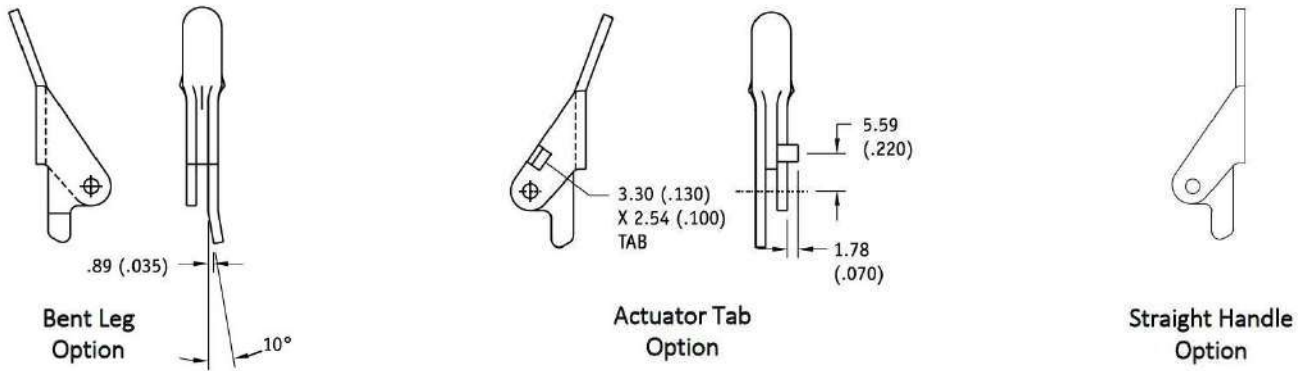

The bent leg option is required when using the extractor with Lok Tainers for PCB retention within sheet metal (non-cold wall) applications. Additionally, if using a lever actuated Lok Tainer, the actuator tab will work in conjunction with the lever to release the PCB.

| Part Number Code | |
|---|--|
| Series 71 Extractor | |
| P S 71 T6 - 2 - L - A - CC - BL - E | |
| Assembly Pin | |
| Pre assembled _____ P | |
| Loose _____ [blank] | |
| Handle | |
| Straight _____ S | |
| Bent (easy grip) _____ [blank] | |
| Material | |
| 6061 Aluminum Alloy _____ T6 | |
| Or select from Materials Table | |
| Board Thickness | |
| 1.6 (.063) _____ 2 | |
| Or choose from the Board Thickness Table | |
| Orientation | |
| Left _____ L | |
| Right _____ R | |
| Actuator Tab option | |
| With actuator tab (for use with Lever Lok Tainers) _____ A | |
| No tab _____ [blank] | |
| Finish | |
| Clear chem film _____ CC | |
| Or choose from Finish Table | |
| Leg Option | |
| Bent (for compatibility with Lok Tainers) _____ BL | |
| No bent leg _____ [blank] | |
| ESD Symbol | |
| ESD silkscreen _____ E | |
| No ESD symbol _____ [blank] | |

MATERIALS TABLE

| DASH # | MATERIAL |
|---------|---|
| [blank] | .063 ALUMINUM ALLOY 5052-H32 PER QQ-A-250/8 |
| T6 | .063 ALUMINUM ALLOY 6061-T6 |

BOARD THICKNESS TABLE

| DASH # | THICKNESS | A | MAX |
|--------|--------------|------------|------------|
| -1 | 0.787 (.031) | 6.35 (.25) | 6.60 (.26) |
| -2 | 1.600 (.063) | 6.35 (.25) | 7.37 (.29) |
| -3 | 2.390 (.094) | 6.35 (.25) | 7.37 (.29) |
| -4 | 3.180 (.125) | 7.37 (.29) | 8.38 (.33) |
| -5 | 3.960 (.156) | 7.37 (.29) | 8.38 (.33) |

FINISH TABLE

| DASH # | FINISH | COLOR |
|---------|--------------------------|--------|
| -1 | ANODIZE PER MIL-A-8625 | RED |
| -2 | ANODIZE PER MIL-A-8625 | BLUE |
| -3 | ANODIZE PER MIL-A-8625 | GREEN |
| -4 | ANODIZE PER MIL-A-8625 | YELLOW |
| -5 | ANODIZE PER MIL-A-8625 | BLACK |
| -6 | ANODIZE PER MIL-A-8625 | ORANGE |
| -7 | ANODIZE PER MIL-A-8625 | PURPLE |
| -8 | ANODIZE PER MIL-A-8625 | GRAY |
| -9 | ANODIZE PER MIL-A-8625 | BROWN |
| -10 | ANODIZE PER MIL-A-8625 | CLEAR |
| -CC | CHEM FILM PER MIL-C-5541 | CLEAR |
| [blank] | CHEM FILM PER MIL-C-5541 | GOLD |



SCHROFF