

Data Sheet | Item Number: 787-1007

Switched-mode power supply; for DALI module (753-647); 1-phase; 18 VDC output voltage; 1.1 A output current; 2,50 mm²

<https://www.wago.com/787-1007>

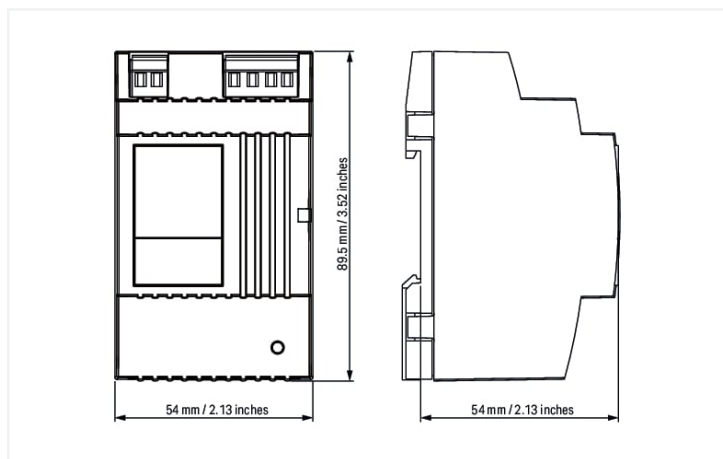
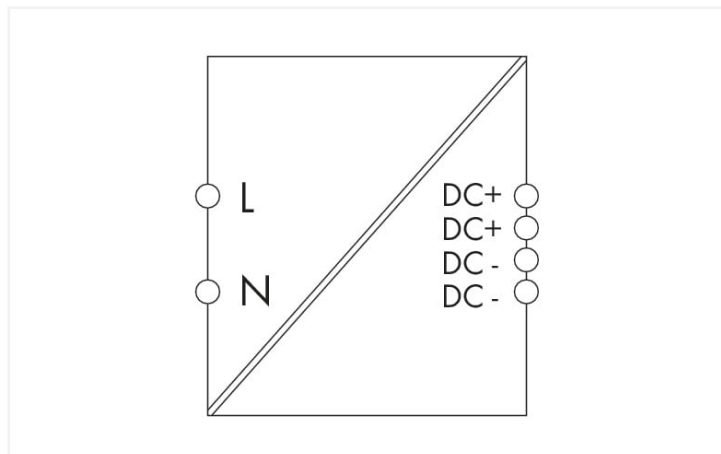

WAGO's 787-1007 Switched-Mode Power Supply is specially designed to supply the 753-647 DALI Multi-Master Module. This unit features a 54 mm wide DIN-rail-mount enclosure with an input voltage range of 85 to 264 VAC (120 ... 300 VDC). The power supply provides an output voltage of 18 VDC and a maximum output current of 1100 mA – enough to supply up to five parallel modules. The maximum current per DALI line is limited to 200 mA in each DALI Multi-Master Module.

- Supplies up to five 753-647 DALI Multi-Master Modules*
- Suitable for protection class II equipment
- Natural convection cooling when horizontally mounted
- Stepped profile, ideal for distribution boards/boxes

Technical data

Input

Phases	1
Nominal input voltage $U_{i, \text{nom}}$	1 x AC 100 ... 240 V
Input voltage range	1 x AC 85 ... 264 V; DC 120 ... 300 V
Nominal mains frequency range	44 ... 66 Hz; 0 Hz
Input current I_i	≤ 0.4 A (230 VAC); ≤ 0.6 A (110 VAC)
Inrush current	≤ 30 A (NTC)
Mains failure hold-up time	≥ 80 ms (230 VAC); ≥ 10 ms (110 VAC)

Output

Nominal output voltage $U_{o, \text{nom}}$	DC 18 V (SELV)
Default setting	DC 18 V
Nominal output current $I_{o, \text{nom}}$	1.1 A (18 VDC); 0.8 A (18 VDC; in any mounting position)
Nominal output power	19.8 W
Deviation	≤ 2 %
Residual ripple	≤ 100 mV (peak-to-peak)
Current limitation	$1.1 \times I_{o, \text{nom}}$ (typ.)
Overload behavior	Constant current

Signaling and communication

Signaling	1 x Status indication LED (green)
Operation status indicator	Green LED (U _o)

Efficiency/power losses

Power loss P _I	≤ 3 W; ≤ 6 W (nominal load)
Efficiency (typ.)	80 %

Circuit protection

Internal fuse	T 2 A / 250 VAC
Backup fusing (required)	An external DC fuse is required for the DC input voltage.
Backup fusing (recommended)	Circuit breaker: 6 A (C characteristic), 10 A (B characteristic) or higher

Safety and protection

Isolation voltage (pri.-sec.)	DC 4.242 kV
Protection class	II
Protection type	IP20; per EN 60529
Resistance to reverse feed	≤ DC 20 V
Overvoltage category	II
Pollution degree	2
Short-circuit-protected	Yes
Open-circuit-proof	Yes
MTBF	> 500,000 h (per IEC 61709)

Connection data

Connection type 1	Input/output
Connection technology	CAGE CLAMP®
WAGO connector	WAGO 740 Series
Solid conductor	0.08 ... 2.5 mm ² / 28 ... 12 AWG
Fine-stranded conductor	0.08 ... 2.5 mm ² / 28 ... 12 AWG
Strip length	6 ... 7 mm / 0.24 ... 0.28 inches

Physical data

Width	54 mm / 2.126 inches
Height	89 mm / 3.504 inches
Depth	59 mm / 2.323 inches
Depth from upper-edge of DIN-rail	55 mm / 2.165 inches

Mechanical data

Housing design	DIN-rail-mount enclosure
Mounting type	DIN-35 rail

Material data

Flammability class per UL94	V0
Fire load	0 MJ
Weight	170 g

Environmental requirements

Ambient temperature (operation)	-25 ... +60 °C
Ambient temperature (storage)	-25 ... +80 °C
Relative humidity	5 ... 96 % (no condensation permissible)
Climatic category	3K3 (per EN 60721)

Standards and specifications

Conformity marking	CE
Standards/specifications	EN 61010-1 EN 61010-2-201 EN 61204-3 UL 60950-1 UL 508 DNV

Commercial data

Product Group	6 (INTERFACE ELECTRONIC)
eCl@ss 10.0	27-04-07-01
eCl@ss 9.0	27-04-07-01
ETIM 8.0	EC002540
ETIM 7.0	EC002540
PU (SPU)	1 pcs
Packaging type	Box
Country of origin	CN
GTIN	4050821430575
Customs tariff number	85044083900

Environmental Product Compliance

RoHS Compliance Status	Compliant, No Exemption
------------------------	-------------------------

Approvals / Certificates

General approvals



Approval	Standard	Certificate Name
EAC GZO Almaty Standart	TP TC 004/2011	EAC CoC 03078
EAC GZO Almaty Standart	TP TC 020/2011	EAC CoC 03081
UL Underwriters Laboratories Inc.	UL 60950-1	E255815

Downloads

Environmental Product Compliance

Compliance Search	
Environmental Product Compliance 787-1007	↓

Documentation

Bid Text			
787-1007	19.02.2019	xml 7.47 KB	↓
787-1007	23.11.2015	doc 31.50 KB	↓
ausschreiben.de 787-1007 ↓			

Instruction Leaflet		
Stromversorgung f. DA-LI-Multi-Master-Klemme 753-647	pdf 161.65 KB	↓

CAD/CAE-Data

CAD data	
2D/3D Models 787-1007	↓

CAE data	
EPLAN Data Portal 787-1007	↓
WSCAD Universe 787-1007	↓
ZUKEN Portal 787-1007	↓

1 Compatible Products

1.1 Optional Accessories

1.1.1 Marking

1.1.1.1 Marking strip



Item No.: 210-831
Marking strips; on reel; 2.3 mm wide; plain; Self-adhesive; white

Item No.: 210-832
Marking strips; on reel; 3 mm wide; plain; Self-adhesive; white

1.1.2 Tool

1.1.2.1 Operating tool



Item No.: 210-720
Operating tool; Blade: 3.5 x 0.5 mm; with a partially insulated shaft; multicoloured

Item No.: 210-769
SCREWDRIVER; green

Subject to changes. Please also observe the further product documentation!

Current addresses can be found at: www.wago.com