



AZM 170SK-11/11ZRKA 24VAC/DC

- 1 Cable entry M 20 x 1.5
- Cut clamp termination
- Thermoplastic enclosure
- Double-insulated
- Compact design
- Interlock with protection against incorrect locking.
- Long life
- High holding force

Data

Ordering data

| | |
|-------------------------------|------------------------------|
| Product type description | AZM 170SK-11/11ZRKA 24VAC/DC |
| Article number (order number) | 101182692 |
| EAN (European Article Number) | 4030661318059 |
| eCl@ss number, version 12.0 | 27-27-26-03 |
| eCl@ss number, version 11.0 | 27-27-26-03 |
| eCl@ss number, version 9.0 | 27-27-26-03 |
| ETIM number, version 7.0 | EC002593 |
| ETIM number, version 6.0 | EC002593 |

Approvals - Standards

| | |
|--------------|--------------------|
| Certificates | BG cULus CCC |
|--------------|--------------------|

General data

| | |
|--|---|
| Standards | EN ISO 13849-1 EN ISO 14119 EN IEC 60947-5-1 |
| Coding level according to EN ISO 14119 | Low |
| Working principle | electromechanical |
| Housing material | Plastic, glass-fibre reinforced thermoplastic, self-extinguishing |
| Gross weight | 300 g |

General data - Features

| | |
|--------------------------------|-----|
| Power to lock | Yes |
| Number of actuating directions | 2 |
| Number of auxiliary contacts | 2 |
| Number of safety contacts | 2 |

Safety classification

| | |
|---|--------------------------------------|
| Standards | EN ISO 13849-1 |
| Performance Level, up to | c |
| Category | 1 |
| B _{10D} Normally-closed contact (NC) | 2,000,000 Operations |
| Note | Electrical life on request. |
| B _{10D} Normally-open contact (NO) | 1,000,000 Operations |
| Note | at 10% I _e and ohmic load |
| Mission time | 20 Year(s) |

Safety classification - Safety outputs

| | |
|--|--------------------------------------|
| Note (B _{10D} Normally open contact (NO)) | at 10% I _e and ohmic load |
|--|--------------------------------------|

Safety classification - Fault exclusion

| | |
|--------------------------|---|
| Please note: | Can be used when fault exclusion for dangerous damage to the 1-channel mechanism is permissible and sufficient protection against manipulation is guaranteed. |
| Performance Level, up to | d |
| Category | 3 |
| Note | for 2-channel use and with suitable logic unit. |
| Mission time | 20 Year(s) |

Mechanical data

| | |
|--|----------------------|
| Mechanical life, minimum | 1,000,000 Operations |
| Holding force F_{Zh} in accordance with EN ISO 14119 | 1,000 N |
| Holding force F_{max} , maximum | 1,300 N |
| Latching force | 30 N |
| Positive break travel | 11 mm |
| Positive break force per NC contact, minimum | 8.5 N |
| Positive break force, minimum | 8.5 N |
| Actuating speed, maximum | 2 m/s |
| Mounting | Screws |
| Type of the fixing screws | 2x M5 |
| Tightening torque of the fastening screws for the housing cover, minimum | 0.7 Nm |
| Tightening torque of the fastening screws for the housing cover, maximum | 1 Nm |
| Note | Torx T10 |

Mechanical data - Connection technique

| | |
|------------------------|---|
| Termination | Screw terminals |
| Cable section, minimum | 0.25 mm ² |
| Cable section, maximum | 1.5 mm ² |
| Note (Cable section) | All indications including the conductor ferrules. |

| | |
|-----------------------|---|
| Allowed type of cable | solid single-wire solid multi-wire flexible |
|-----------------------|---|

Mechanical data - Dimensions

| | |
|------------------|----------|
| Length of sensor | 30 mm |
| Height of sensor | 100.5 mm |

Ambient conditions

| | |
|--|----------------|
| Degree of protection | IP67 |
| Ambient temperature | -25 ... +60 °C |
| Storage and transport temperature, minimum | -25 °C |
| Storage and transport temperature, maximum | +85 °C |
| Protection class | II |
| Permissible installation altitude above sea level, maximum | 2,000 m |

Ambient conditions - Insulation values

| | |
|---|---------|
| Rated insulation voltage U_i | 250 VAC |
| Rated impulse withstand voltage U_{imp} | 4 kV |
| Overvoltage category | III |
| Degree of pollution | 3 |

Electrical data

| | |
|---------------------------------------|------------------------|
| Thermal test current | 6 A |
| Rated control voltage | 24 VAC/DC |
| Required rated short-circuit current | 1,000 A |
| Electrical power consumption, maximum | 12 W |
| Switching element | NO contact, NC contact |

| | |
|--------------------------------------|--|
| Note (Switching element) | Change-over contact with double break, type Zb or 2 NC contacts, with galvanically separated contact bridges |
| Switching principle | slow action, positive break NC contact |
| Switching frequency | 1,000 /h |
| Material of the contacts, electrical | Silver |

Electrical data - Magnet control

| | |
|------------------------------|-------|
| Magnet switch-on time | 100 % |
| Test pulse duration, maximum | 5 ms |
| Test pulse interval, minimum | 50 ms |

Electrical data - Safety contacts

| | |
|-------------------------------------|---------|
| Voltage, Utilisation category AC-15 | 230 VAC |
| Current, Utilisation category AC-15 | 4 A |
| Voltage, Utilisation category DC-13 | 24 VDC |
| Current, Utilisation category DC-13 | 4 A |

Electrical data - Auxiliary contacts

| | |
|-------------------------------------|---------|
| Voltage, Utilisation category AC-15 | 230 VAC |
| Current, Utilisation category AC-15 | 4 A |
| Voltage, Utilisation category DC-13 | 24 VDC |
| Current, Utilisation category DC-13 | 4 A |

Other data

| | |
|---------------------|--|
| Note (applications) | sliding safety guard removable guard hinged safety guard |
|---------------------|--|

Scope of delivery

| | |
|-------------------|--------------------------------------|
| Scope of delivery | Actuator must be ordered separately. |
|-------------------|--------------------------------------|

Ordering code

Product type description:

AZM 170(1)-(2)Z(3)K(4)-(5)-(6)-(7)-(8)

(1)

without

Cut clamps

SK

Screw connection

(2)

11

1 NO contacts/1 NC contact

02

2 NC contact

(3)

without

Latching force 5 N

R

Latching force 30 N

(4)

without

Power to unlock

A

Power to lock

(5)

without

Cable entry M20

ST

2 connector, M12, 4-pin

ST-2431

As well as ST; individual solenoid monitoring

ST8

Connector M12 8-pole

(6)

24VAC/DC

Us 24 VAC/DC

110VAC

Us 110 VAC

230VAC

Us 230 VAC

(7)

1637

Gold-plated contacts

(8)

without

Manual release

2197

Manual release from side (Standard in case of conector and power to unlock versions)

Pictures

Product picture (catalogue individual photo)



ID: kazm1f59

| 740.5 kB | .jpg | 352.778 x 395.111 mm - 1000 x 1120 px - 72 dpi

| 55.4 kB | .png | 74.083 x 82.903 mm - 210 x 235 px - 72 dpi

| 64.2 kB | .jpg | 110.419 x 123.472 mm - 313 x 350 px - 72 dpi

Dimensional drawing basic component

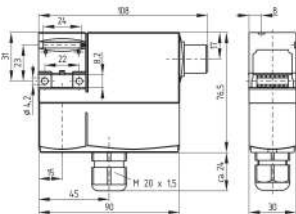

ID: lazmg07

| 44.4 kB | .cdr |

| 10.1 kB | .png | 74.083 x 51.506 mm - 210 x 146 px - 72 dpi

| 126.8 kB | .jpg | 352.778 x 245.181 mm - 1000 x 695 px - 72 dpi

Diagram

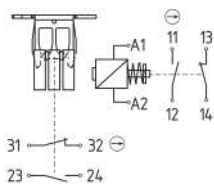

ID: kazm1k78

| 31.7 kB | .cdr |

| 94.6 kB | .jpg | 352.778 x 268.464 mm - 1000 x 761 px - 72 dpi

| 4.8 kB | .png | 74.083 x 56.444 mm - 210 x 160 px - 72 dpi

| | | | | | | | | | |
|----|----|----|----|----|----|----|----|----|----|
| 11 | 12 | 13 | 14 | 23 | 24 | 31 | 32 | A1 | A2 |
|----|----|----|----|----|----|----|----|----|----|

Schmersal India Pvt. Ltd., Plot No - G-7/1, Ranjangaon MIDC, Tal. - Shirur, Dist.- Pune 412 220

The details and data referred to have been carefully checked. Images may diverge from original. Further technical data can be found in the manual. Technical amendments and errors possible.

Generated on: 11/12/2023, 6:07 am